



PLAN OF LAND TO BE ACQUIRED PERMANENTLY FOR THE PURPOSE OF EXCAVATION OF A MINOR OFFTAKING FROM TAIL-END OF MR-4 OF DY-15 EX. K.S.M.C. IN MOUZA: SAHAPUR, J.L. No. 124, P.S. BHARATPUR, DT. MURSHIDABAD.

SCALE: 330' = 1"



REF

LAND TO BE ACQUIRED PERMANENTLY SHOWN THUS... 
 VESTED LAND NOT TO BE ACQUIRED SHOWN THUS... 

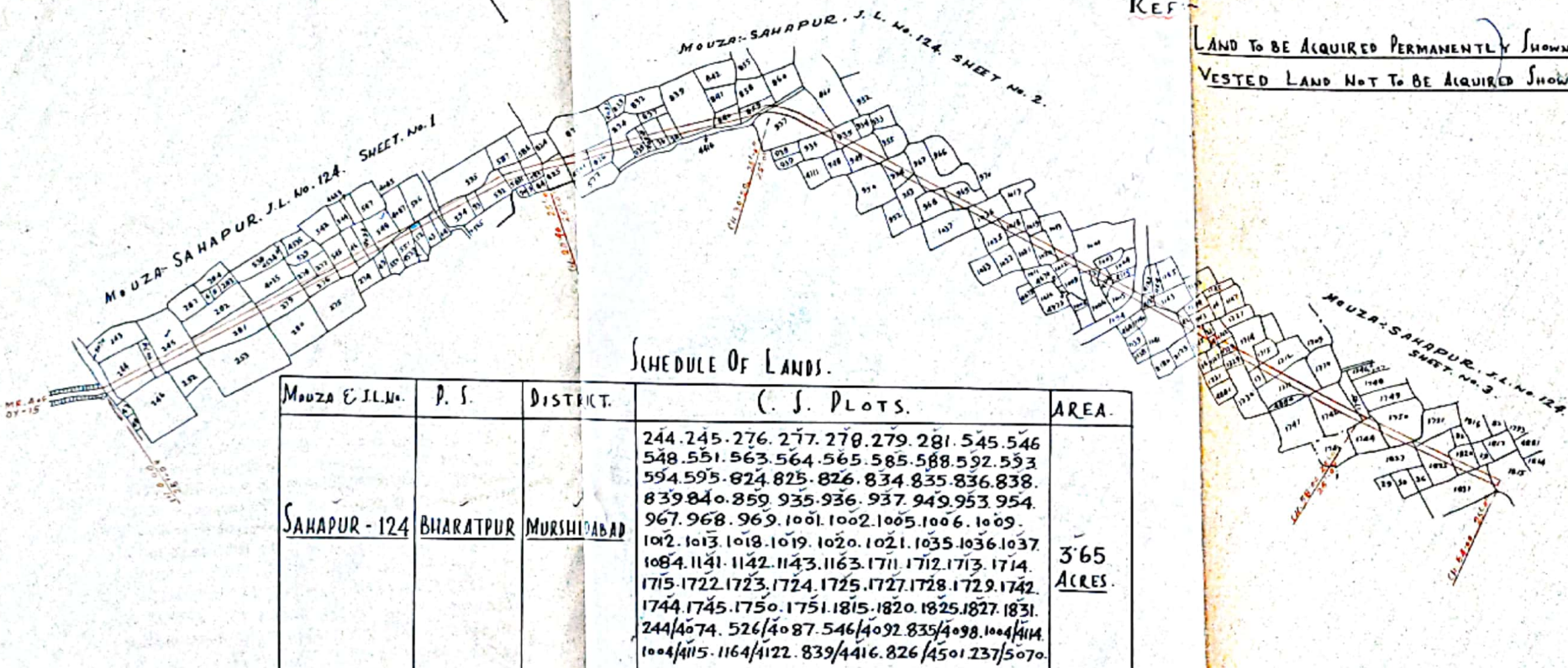

SCHEDULE OF LANDS.

MOUZA & J.L. No.	P. S.	DISTRICT.	C. S. PLOTS.	AREA.
SAHAPUR - 124	BHARATPUR	MURSHIDABAD	244. 245. 276. 277. 278. 279. 281. 545. 546	3.65 ACRES.
			548. 551. 563. 564. 565. 585. 588. 592. 593	
			594. 595. 824. 825. 826. 834. 835. 836. 838.	
			839. 840. 859. 935. 936. 937. 949. 953. 954.	
			967. 968. 969. 1001. 1002. 1005. 1006. 1009.	
			1012. 1013. 1018. 1019. 1020. 1021. 1035. 1036. 1037.	
			1084. 1141. 1142. 1143. 1163. 1711. 1712. 1713. 1714.	
			1715. 1722. 1723. 1724. 1725. 1727. 1728. 1729. 1742.	
			1744. 1745. 1750. 1751. 1815. 1820. 1825. 1827. 1831.	
			244/4074. 526/4087. 546/4092. 835/4098. 1004/4114.	
			1004/4115. 1164/4122. 839/4416. 826/4501. 237/5070.	

PREPARED BY *[Signature]*
3/1/17

(KD. BY *[Signature]*)
1/1/17

[Signature]
SPL. L.A. COLLECTOR.
BIRBHUM.