

PLAN OF LAND TO BE ACQUIRED
SUB MINOR NO. M.D.B/14/14 (B) SMALL MINOR NO.
WATER-COURSE IN MOUZAS- SADPUR. J.L. NO.
J.L. NO. 65. P.S. KANDI, DT. MURSHIDABAD.

SCALE - 330' = 1"

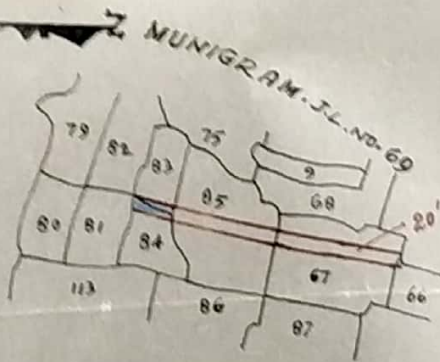
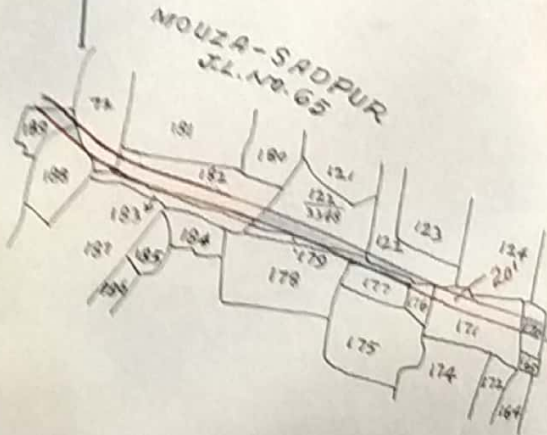

77/73-74

REF:-

1. LAND ALREADY ACQUIRED FOR (a) SUB-MINOR AND (b) SMALL-MINOR SHOWN THIS
2. LAND TO BE ACQUIRED SHOWN THIS
3. PARTLY VESTED AND PARTLY RETAINED OF PLOTS NOS. 72 & 182 IN MOUZA- SADPUR. J.L. NO. 65.

PLOT SCHEDULE.

| MOUZA & J.L. NOS. | P. S. | DT. | C. S. PLOTS IN PART | |
|---|--------------|--------------------|---------------------|-----------------------|
| <u>SADPUR,</u> <u>J.L. NO. 65.</u> | <u>KANDI</u> | <u>MURSHIDABAD</u> | 171, 176, 72 & 182. | <u>*26 OF ANACRE.</u> |
| <u>MUNIGRAM,</u> <u>J.L. NO. 69.</u> | <u>KANDI</u> | <u>MURSHIDABAD</u> | 67 & 85. | <u>*19 OF ANACRE.</u> |

TOTAL AREA:- *45 OF AN ACRE.

PREPARED BY:- *[Signature]*
 2/8/74

CKD. BY:-
[Signature]
 2/8/74
 L.A. 1090

[Signature]
 2/8/74
SPL. L.A. OFFICER,
BIRBHUM.