



Plan of lands to be acquired herewith for excavation of Minor No. 4 from tailend of Dr. No. 9 Ex. R. G. M. C. With its water course from ch. 00 to ch. 30.00  
 p.p.:- Nanur District:- Birbhurn. in mouza of Feugram d.L. No:- 32  
 1) Palashi d.L. No:- 72.

REFERENCE

- a) Land already acquired: ~ 
- b) Land to be acquired shown: ~ 
- c) Vested land not to be acquired: ~ 

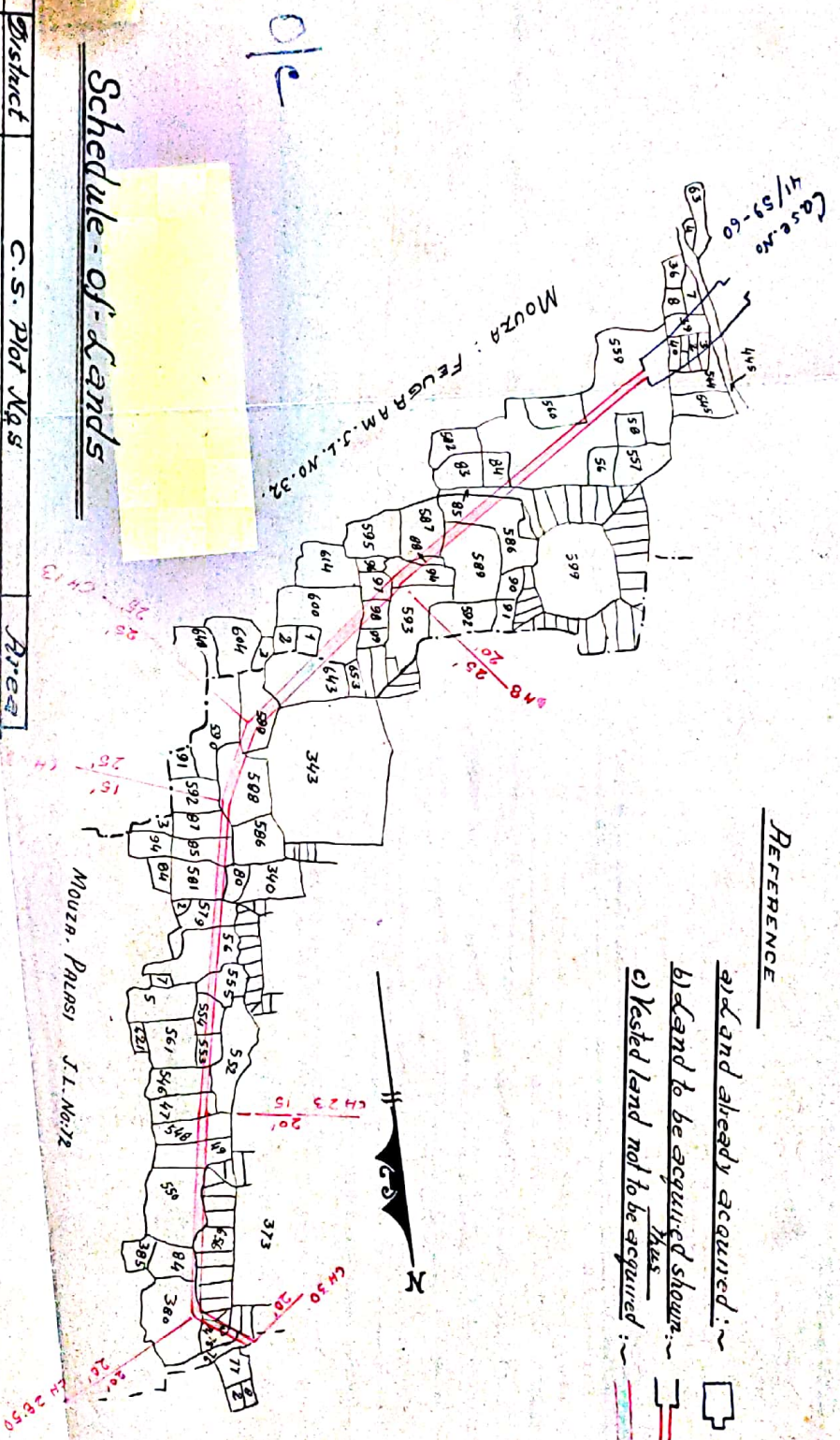

Schedule of Lands

Mouza	J.L. No.	Tahsil	District	C.S. Plot Nos.	Area
Feugram	32	Nanur	Birbhurn	559, 560, 584, 586, 587, 588, 589, 593, 594, 597, 598, 600	1.18 Acres
Palashi	72	Lahpur	"	375, 376, 380, 384, 546, 548, 547, 549, 550, 553, 554, 555, 556, 579, 581, 585, 587, 588 & 589 in part	4.775 Hectors
				374 in full.	

Traced By: Sudhakar Das  
 20.1.70

CKD. BY: Sudhakar Das

Hdd. L. H. COLLECTOR, BIRBHURN.