

UPPLIMENTARY LAND ACQUISITION PROPOSAL FOR CONSTRUCTION OF ROB AT KM 307.050 (BHIMGARH) OF NH 60 IN BIRBHUM DISTRICT, WEST BENGAL

Mouza - Bhimgarh
Mouza - Ishgara
Mouza - Narayanpur
Mouza - Beledanga

J.L. No - 139
J.L. No - 140
J.L. No - 141
J.L. No - 142

P.S. - Khoyrasol
P.S. - Khoyrasol
P.S. - Khoyrasol
P.S. - Khoyrasol

District - Birbhum
District - Birbhum
District - Birbhum
District - Birbhum

Chainage from 306+302 Km to 307+923 Km
Length - 1.621 Km

LEGEND :-
Prop. CL
Prop. Acquisition

Scale: 16" = 1 Mile
Proposal No: 01

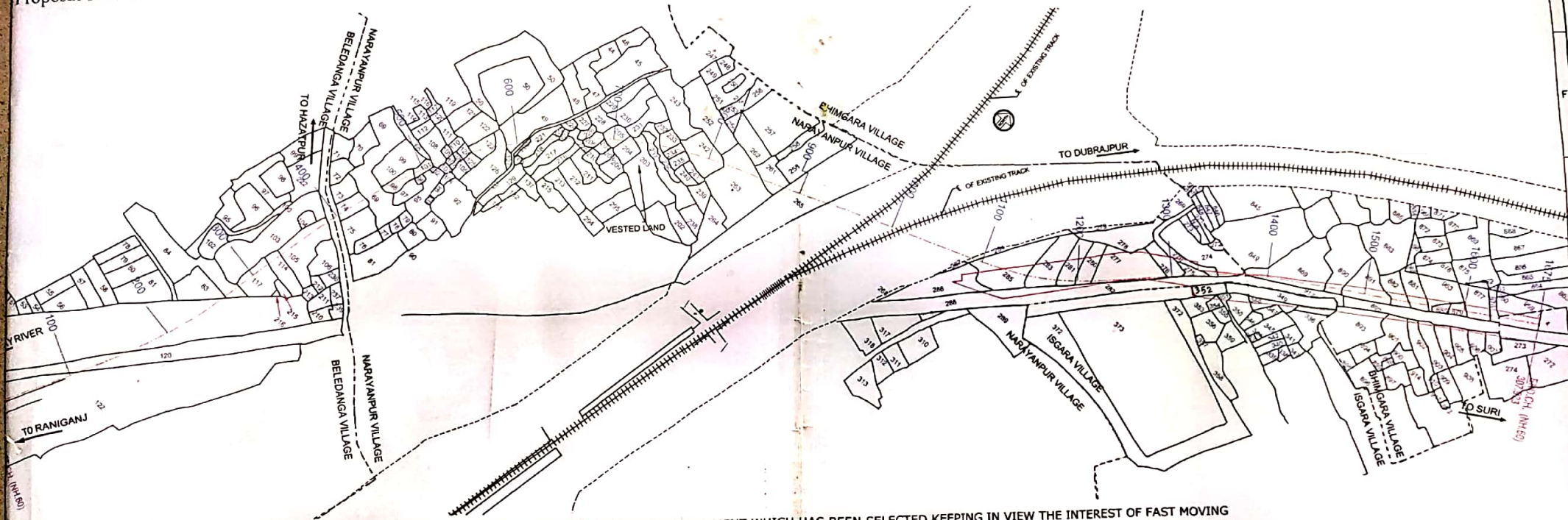

CERTIFIED THAT, I AM PERSONALLY SATISFIED WITH THE ROAD ALIGNMENT WHICH HAS BEEN SELECTED KEEPING IN VIEW THE INTEREST OF FAST MOVING TRAFFIC ALONG WITH MINIMUM ACQUISITION OF VALUABLE LAND AND HOMESTEADS WHICH ARE ESSENTIAL TO BE ACQUIRED FOR THE CONSTRUCTION / IMPROVEMENT OF THE ROAD AND CAN NOT BE AVOIDED.

Basic Grade Surveyor
NH Planning & Design Division-II
P.W. (Roads) Directorate

Junior Engineer
NH Planning & Design Division-II
P.W. (Roads) Directorate

Assistant Engineer
NH Planning & Design Division-II
P.W. (Roads) Directorate

Executive Engineer
NH Planning & Design Division-II
P.W. (Roads) Directorate

Superintending Engineer
NH Planning & Design Circle
P.W. (Roads) Directorate

MINISTRY OF ROAD
TRANSPORT & HIGHWAYS
GOVERNMENT OF INDIA



Chaitanya Projects Consultancy Pvt. Ltd.
C-5, 2ND FLOOR, R.K. TOWER, PLOT NO. 21-22,
SECTOR-4, VAISHALI, GHAZIABAD
PH: 0120-4120472, FAX: 0120-4110472

PROJECT :-

CONSTRUCTION OF ROB AND ITS APPROACHES IN LIEU OF LEVEL CROSSING NO. 10-B/T AT KM.307.050 OF NH-60 IN THE DISTRICT OF BIRBHUM, WEST BENGAL

SCALE:-
1:3960
16" = 1 Mile

DWG TITLE :-
LAND ACQUISITION PLAN
LC GATE NO. 10-B/T
AT KM. 307.050

DRAWING No :
P-109/L.C. NO.10-B/T/PLAN-01

PREPARED BY
P.K. SHUKLA

DESIGNED BY
NEERAJ

APPROVED BY
S.K. SINHA

ACTUAL SHEET SIZE -

10 9 8 7 6 5 4 3 2 **SUPPLEMENTARY LAND ACQUISITION PROPOSAL FOR CONSTRUCTION OF ROB AT KM 307.050 (BHIMGARH) OF NH 60 IN BIRBHUM DISTI**

Mouza - Bhimgarh
Mouza - Ishgara
Mouza - Narayanpur
Mouza - Beledanga

J.L. No - 139
J.L. No - 140
J.L. No - 141
J.L. No - 142

P.S. - Khoyrasol
P.S. - Khoyrasol
P.S. - Khoyrasol
P.S. - Khoyrasol

District - Birbhum
District - Birbhum
District - Birbhum
District - Birbhum

Chainage from 306+302 Km to 307+923 Km
 Length - 1.621 Km

Scale: 16" = 1 Mile
 Proposal No: 01

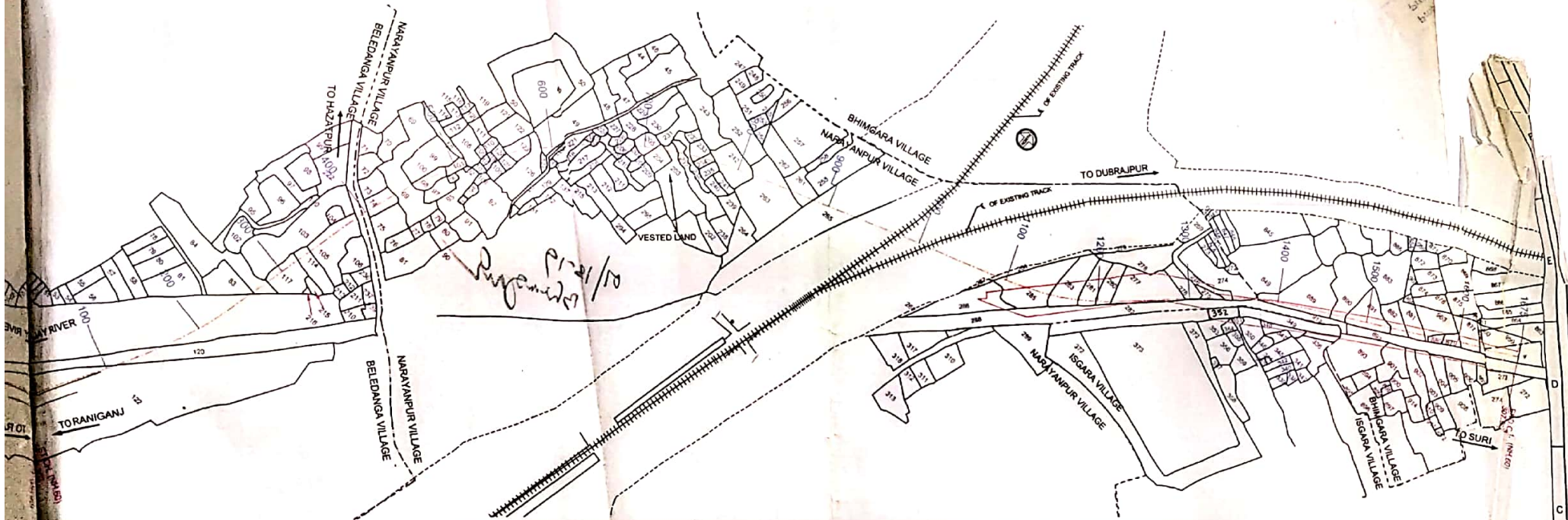

CERTIFIED THAT, I AM PERSONALLY SATISFIED WITH THE ROAD ALIGNMENT WHICH HAS BEEN SELECTED KEEPING IN VIEW THE INTEREST OF FAST MOVING TRAFFIC ALONG WITH MINIMUM ACQUISITION OF VALUABLE LAND AND HOMESTEADS WHICH ARE ESSENTIAL TO BE ACQUIRED FOR THE CONSTRUCTION / IMPROVEMENT OF THE ROAD AND CAN NOT BE AVOIDED.

[Signature]
 Basic Grade Surveyor
 NH Planning & Design Division-II
 P.W. (Roads) Directorate

[Signature]
 Junior Engineer
 NH Planning & Design Division-II
 P.W. (Roads) Directorate

[Signature]
 Assistant Engineer
 NH Planning & Design Division-II
 P.W. (Roads) Directorate

[Signature]
 Executive Engineer
 NH Planning & Design Division-II
 P.W. (Roads) Directorate

[Signature]
 Superintending Engineer
 NH Planning & Design Circle
 P.W. (Roads) Directorate

MINISTRY OF ROAD
 TRANSPORT & HIGHWAYS
 GOVERNMENT OF INDIA



Chaitanya Projects Consultancy Pvt. Ltd.
 C-6, 2ND FLOOR, R.K. TOWER, PLOT NO.-21-22,
 SECTOR-4, VAISHALI, GHAZIABAD
 PH.: 0120-4120472, FAX: 0120-4110472

PROJECT :-

CONSTRUCTION OF ROB AND ITS APPROACHES IN LIEU OF LEVEL CROSSING NO. 10-B/T AT KM.307.050 OF NH-60 IN THE DISTRICT OF BIRBHUM, WEST BENGAL

SCALE:-
 1:3960
 16" = 1 Mile

DWG TITLE :-
 LAND ACQUISITION PLAN
 LC GATE NO. 10-B/T
 AT KM. 307.050

DRAWING No : P-109/L.C. NO. 10-B/T/LA PLAN-01		
PREPARED BY P.K. SHUKLA	DESIGNED BY NEERU	APPROVED BY S.K. BHARMA

ACTUAL SHEET SIZE - A3