

PLAN
OF ADDL. LAND TO BE ACQUIRED PERMANENTLY FOR THE
CONSTRUCTION OF MOLLARPUR-RAMPURHAT-NALHATI
S.H. MOUZA: NALHATI: J.L. No 53, THANA: NALHATI,

DI: BIRBHUM.

Scale: 16" = 1 Mile

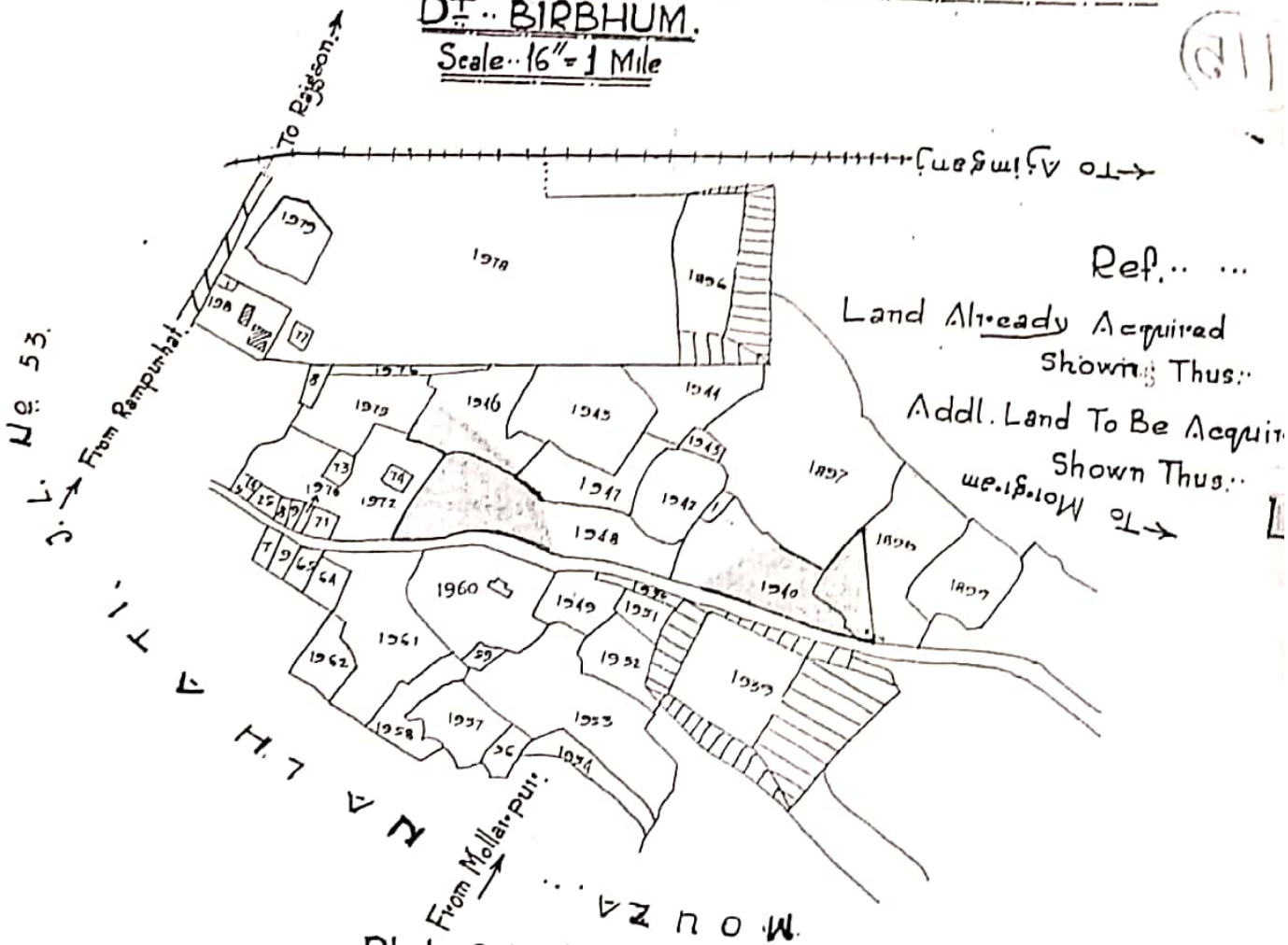

Plot-Schedule

Mouza.	J.L.No	Thana.	District.	C.S. Plot Nos In Part	Area.
Nalhati.	53.	Nalhati.	Birbhum.	1938, 1940, 1946, 1947 And 1948.	2.00 Acres.

CKD BY

A.S.B.
Sharma.
 11/8/59.

Addl. L.A. Collector.
Birbhum.