

AN OF LAND TO [REDACTED] FOR EXCAVATION OF DISTY. NO. 7A OF
M.D.B. OF MOUZA-HATISALA. J.L. NO. 141. P.S. BURWAN. DT. MURSHIDABAD.

SCALE - 16" = 1 MILE.

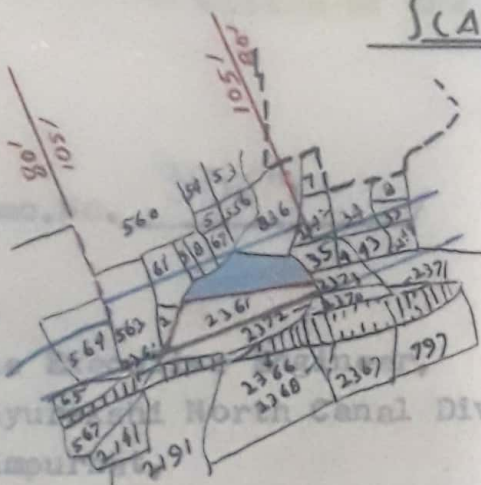

REF:-

LAND ALREADY ACQUIRED PERMT.

SHOWN THUS

LAND TO BE ACQUIRED PERMT.

SHOWN THUS

VESTED - PORTION OF LAND

SHOWN THUS

PLOT - SCHEDULE

MOUZA & J.L. NO.	P.S.	DT.	C.S. PLOT NO	AREA.
HATISALA J.L. NO. 141	BURWAN	MURSHIDA- BAD.	796/2361 IN PART.	0.22 OF AN ACRE.

PREPARED BY:

CKD BY:

SPL. L.A. OFFICER,
BIRBHUM.

Sanctioned estimate with copies of 4A and 4B are hereby
forwarded to his vide No. 1872-75/L.A.7 dt. 10.5.79.
How tested true copies of 4A and 4B are hereby
again submitted.