

PLAN OF LAND TO BE ACQD. FOR STALK
YARD, GUARD'S SHED E.T.C. ON SURI-AMJORA
ROAD IN MOUZA... ARAIPUR, J.L. No. 6
UNDER P.S. SURI, Dt. BIRBHUM.
SCALE 16" = 1 MILE.

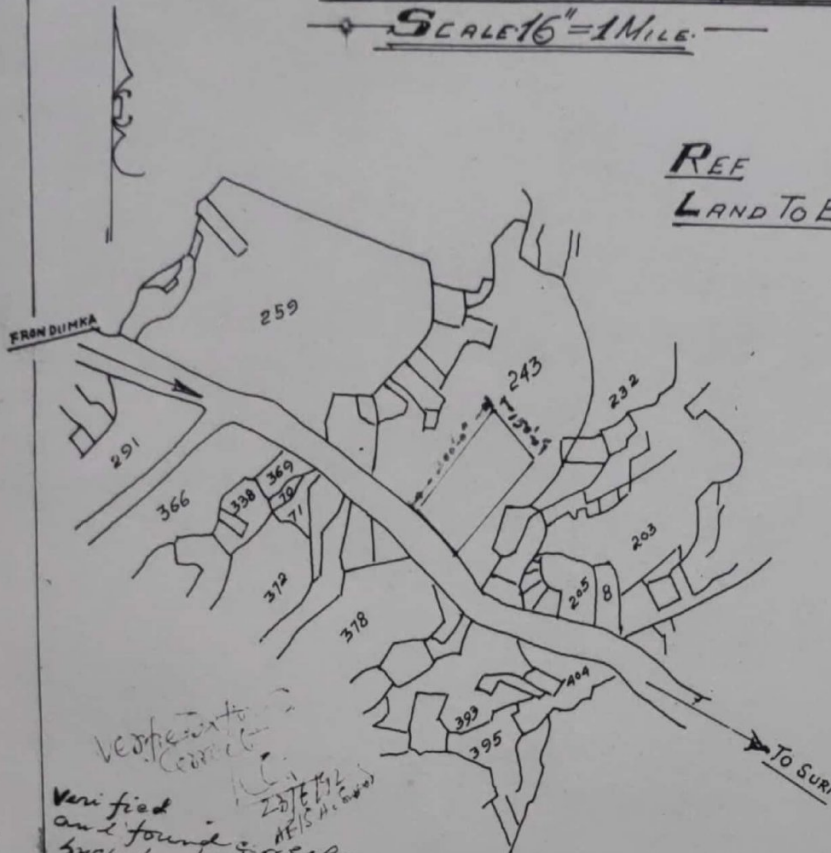

REF
 LAND TO BE ACQD. SHOWN THUS



Verified
 and found correct
 by the
 E.E. & H. Rds
 23/6/92

SCHEDULE OF LAND.

Mouza.	J.L. No.	P.S.	District	R.G. Plot in Part	Area
ARAIPUR	6	Suri	Birbhum	243 Only	1.03 Acre or 4168 sq. ft.

PREPARED BY

SP. L. A. OFFICER
 BIRBHUM.

ADDL. DISTRICT MAGISTRATE
 BIRBHUM.

Chd
 Bano
 23/6/92

True Copy

PLAN OF LAND TO BE ACQ.D. FOR STALK-
YARD, GUAD'S SHED ETC. ON SURI-AMJORA
ROAD IN MOUZA. ARAIPUR J.L. No. 6
UNDER P.S. SURI; DT. BIRBHUM.
SCALE - 16" = 1 MILE.

REF.

LAND TO BE ACQ.D. SHOWN THUS
LAND TO BE ACQ.D. SHOWN THUS



SCHEDULE OF LAND

Mouza	J.L. No.	P.S.	District	R.G. Plot in Part	Area
Araipur	6	Suri	Birbhum	243 only.	1.03 Acres 9158 Sq. Yds.

PREPARED BY

Chd
Suri
23/6/92

Spl.

L.A. OFFICER
BIRBHUM.

ADDL DISTRICT MAGISTRAR

BIRBHUM

**PLAN OF LAND TO BE ACQ.D. FOR STACK
YARD, GUARD'S SHED E.T.C. ON SURI-AMJORA
ROAD IN MOUZA. ARAIPUR. J.L. NO. 6
UNDER P.S. SURI, DT. BIRBHUM.**

SCALE 16"=1 MILE

Now there is hereby given that **LAND TO BE ACQ.D. SHOWN THUS** [Red Box] section the said Act the Governor acquires such land being required for a public purpose as aforesaid.

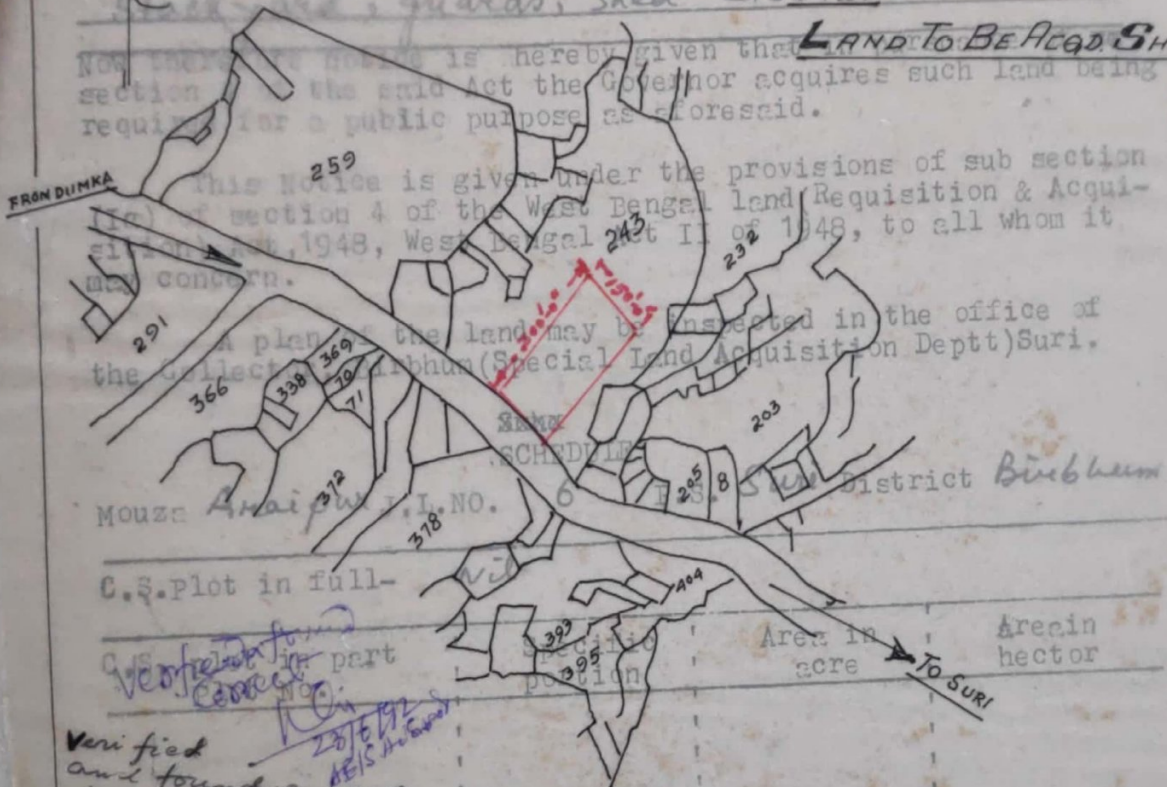

Verified and found correct
23/6/92
E.E.D.H. Rds
Birbhum
Highway
P.W. (Roads) Division

SCHEDULE OF LAND.

Mouza.	J.L. NO.	P.S.	District	R.G. Plot in Part	Area
Araipur	6	Suri	Birbhum	243 Only	1.03 Acre or 4168 Hectares

PREPARED BY

L.A. OFFICER

ADDL. DISTRICT MAGISTRATE

BIRBHUM. **BIRBHUM.**
K.G.O. 23/6/92 Spl/Adl. L.A. Collector, Additional District Magis-
trate. Govt. of W.B.