

Plan Of land to be acquired Per manently for the Construction Of the Water-Course
 from tail end (ch. 73.00) Of the Proposed new minor BNM/172 In mouza:- Belaipara
 No:- 25. P. S- Sagaridighi. Dist:- Murshidabad.

Scale:- 330' = 1"

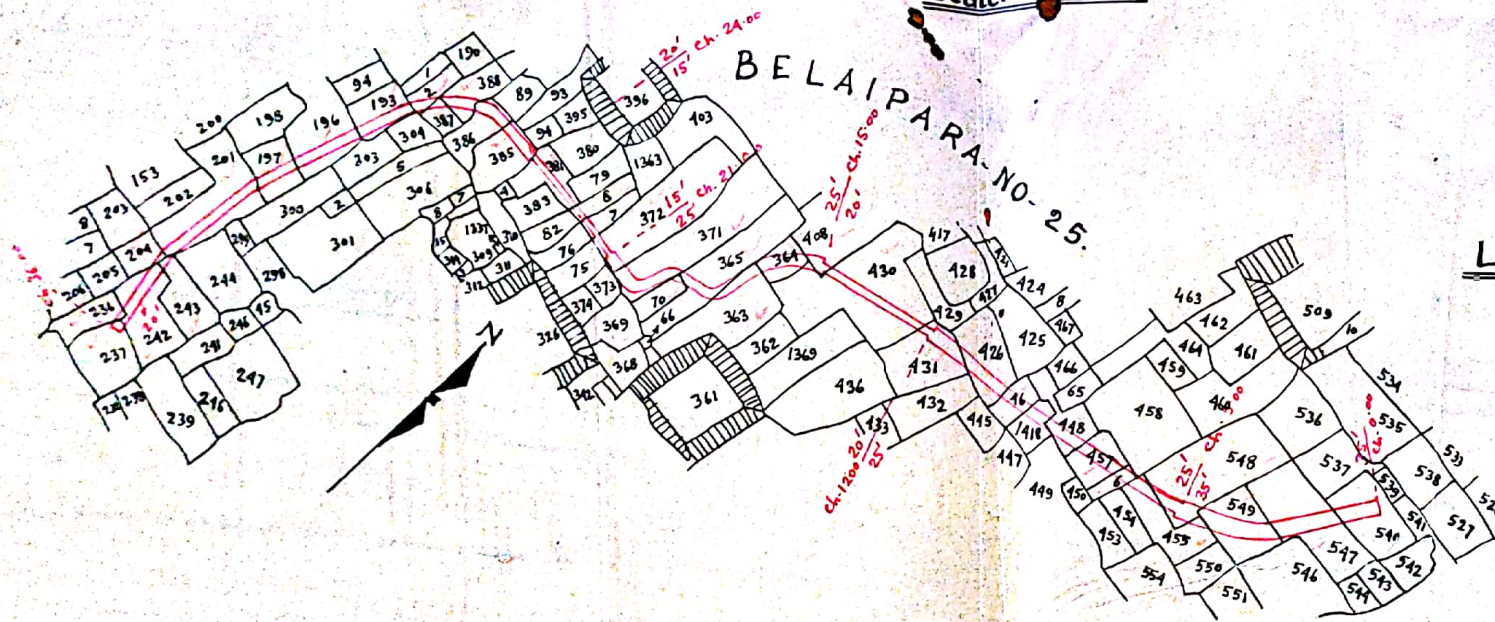

Land to be acquired Shown thus:- ———

MOUZA & JLNO.	P. S.	DIST.	C. S. PLOTS.	AREA.
<u>Belaipara</u> <u>NO-25</u>	<u>Sagaridighi</u>	<u>Murshidabad.</u>	C.S. Plot in part:- 192, 193, 196, 197, 201, 204, 236, 237, 242, 243, 363, 364, 365, 370, 371, 372, 377, 378, 381, 385, 386, 387, 388, 408, 426, 430, 431, 446, 447, 448, 449, 450, 451, 452, 453, 454, 455, 456, 457, 458, 459, 460, 461, 462, 463, 464, 465, 466, 467, 468, 469, 470, 471, 472, 473, 474, 475, 476, 477, 478, 479, 480, 481, 482, 483, 484, 485, 486, 487, 488, 489, 490, 491, 492, 493, 494, 495, 496, 497, 498, 499, 500, 501, 502, 503, 504, 505, 506, 507, 508, 509, 510, 511, 512, 513, 514, 515, 516, 517, 518, 519, 520, 521, 522, 523, 524, 525, 526, 527, 528, 529, 530, 531, 532, 533, 534, 535, 536, 537, 538, 539, 540, 541, 542, 543, 544, 545, 546, 547, 548, 549, 550, 551, 552, 553, 554, 555, 556, 557, 558, 559, 560, 561, 562, 563, 564, 565, 566, 567, 568, 569, 570, 571, 572, 573, 574, 575, 576, 577, 578, 579, 580, 581, 582, 583, 584, 585, 586, 587, 588, 589, 590, 591, 592, 593, 594, 595, 596, 597, 598, 599, 600.	1.94 acres. or .7851 Hectar.

Traced by:- *[Signature]*
4/2/70

Ckd. by:- *[Signature]*
16.2.70
K.S.

[Signature]
Spl. L.A. Officer
Birbhum.