



Plan of Land to be acquired permanently for construction of Panasarih-  
-Dubrajpur-Nalhati-Moregram (widening & strengthening) A.D.B. Assisted - -  
Programme on 25th 26th 34th & 4th K.M. in MOUZA- BARUIPUR-NO-92- SUMUNI-NO-84.  
P.S.-ILLAMBAZAR, BIJORI-NO-164 & RENANA-NO-163. - P.S.-DUBRAJPUR. DT.-BIRBHUM.

SCALE :- 330'0"=1"

Ref:-

1. Homestead Land shown thus: 
2. Religious Place 

Ref:-

3. Land to be Acqd. shown thus: 

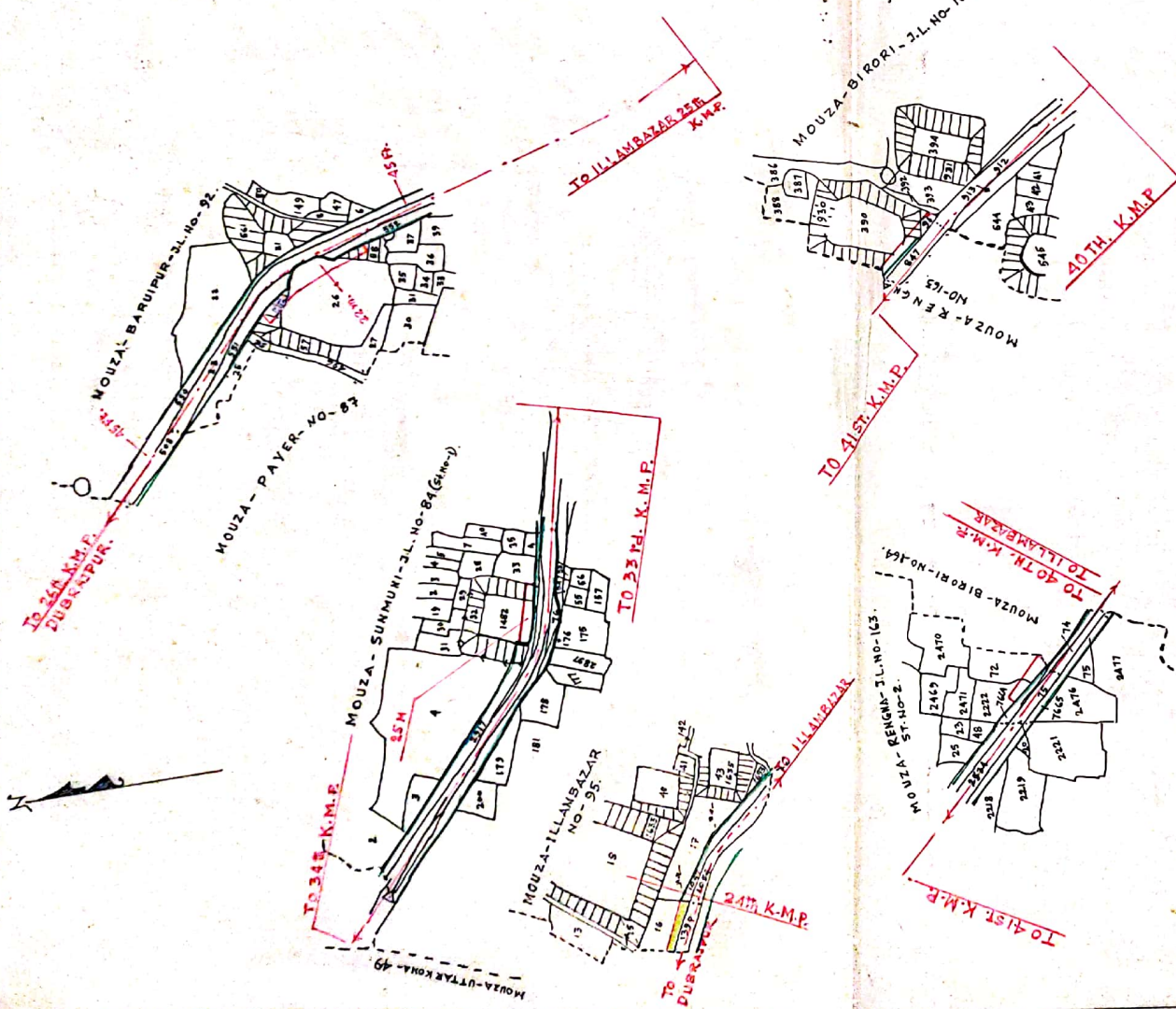

Schedule of Lands

MOUZA & T.L. NO.	P. S.	DIST.	R. S. PLOTS.	AREA.
BARUIPUR- 92.	ILLAMBAZAR.	BIJ-BHUM.	26. 26/557. 26/558. IN PART.	0.69 of an acre.
SUMUNI- 84.	DO.	DO.	32. 32/1482. IN PART.	OR
BIJORI - 164.	DO.	DO.	390. 391. IN PART. 390/930.	0.2792 Hectares.
RENANA-163.	DO.	DO.	2472. 2222. IN PART.	

Drawn by: *Shreyas*  
12.7.92

Verified by: *28/8/1993*

Com *37/93*  
Addl. L.A. Officer  
Birbhum.

*28/8/1993*  
Addl. District Magistrate  
Birbhum.



L. A. PLAN FOR  
STRENGTHENING AND WIDENING (TO TWO LANES) OF  
PANAGAR - DUBRAJPUR - NALHATI - MOREGRAM ROAD

P. S. - ILLAMBAZAR : DIST. - BIRBHUM

SCALE :- 330' = 1"

NOTES

- LAND ALREADY ACQUIRED ———
- LAND TO BE ACQUIRED ———
- DISTANCE MEASURED FROM CENTRE LINE



MOUZA - SUNMUNI - 84/1

MOUZA - UTTARKONA  
 J.L. NO - 49/2

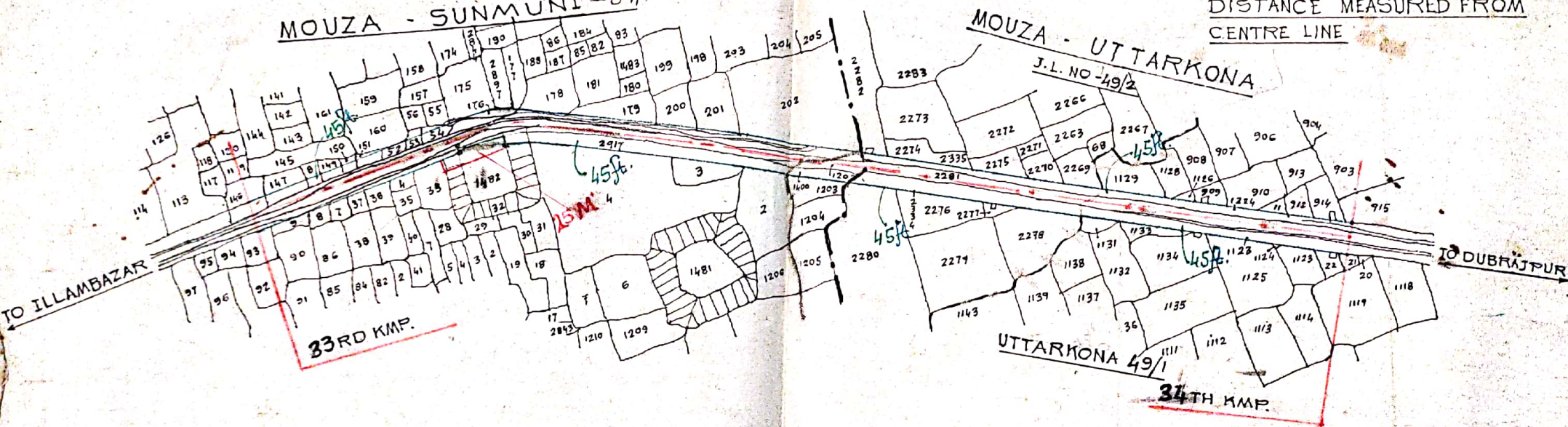

CERTIFIED THAT I AM PERSONALLY SATISFIED WITH THE ROAD ALIGNMENT WHICH  
HAS BEEN SELECTED KEEPING IN VIEW THE INTERESTS OF FAST TRAFFIC CONSISTENT  
WITH THE MINIMUM ACQUISITION OF VALUABLE LAND AND HOMESTEADS. HOMESTEADS  
AND LAND PROPOSED TO BE ACQUIRED ARE ESSENTIAL FOR THE CONSTRUCTION/  
IMPROVEMENT OF THE ROAD AND CANNOT BE AVOIDED.

*DB*  
 (B. DATTA)  
 DRAWN BY

*S.D. Dasgupta*  
 (S. DASGUPTA)  
 ASSTT. ENGINEER  
 HIGHWAY SURVEY DIVISION - I

*Aban*  
 24/6/91  
 (A.M. DAM)  
 EXECUTIVE ENGINEER

*Dasa* 24/6/91  
 (D.B. BANERJEE)  
 SUPDT. ENGINEER  
 S.H.P. CIRCLE



L. A. PLAN FOR  
STRENGTHENING AND WIDENING (TO TWO LANES) OF  
PANAGAR-DUBRAJPUR-NALHATI-MOREGRAM ROAD  
P.S. - DUBRAJPUR . DIST. - BIRBHUM .

NOTES:

1. LAND ALREADY ACQUIRED -
2. LAND TO BE ACQUIRED -
3. DISTANCE MEASURED FROM CENTRE LINE.

SCALE : 330' = 1"



MOUZA - BIRORI 164

MOUZA - RENGNA 163/2

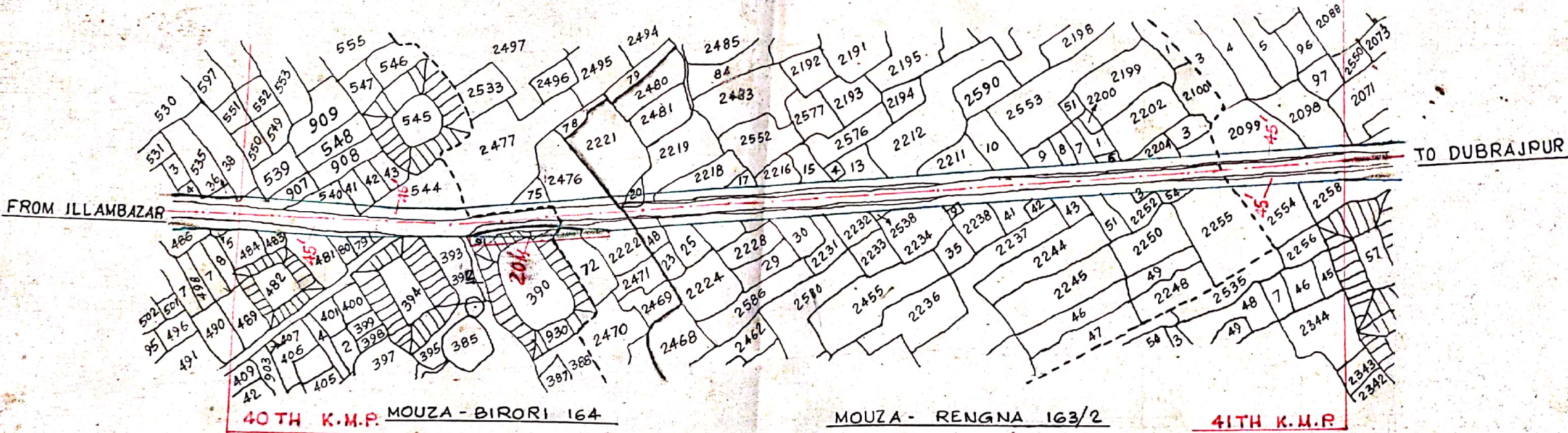

CERTIFIED THAT I AM PERSONALLY SATISFIED WITH THE ROAD ALIGNMENT  
WHICH HAS BEEN SELECTED KEEPING IN VIEW THE INTERESTS OF FAST TRAFFIC  
CONSISTENT WITH THE MINIMUM ACQUISITION OF VALUABLE LAND AND HOMESTEADS.  
HOMESTEADS AND LAND PROPOSED TO BE ACQUIRED ARE ESSENTIAL FOR THE  
CONSTRUCTION/IMPROVEMENT OF THE ROAD AND CAN NOT BE AVOIDED.

DRAWN BY :- Swapan Kumar K.

S. Dasgupta  
 24.6.91.  
 (S. DASGUPTA)  
 ASSTT. ENGINEER  
 HIGHWAY SURVEY

(A.K. DAM.)  
 EXECUTIVE ENGINEER  
 DIVISION NO - I

(D. B. BANER)  
 SUPDT. ENGINEER  
 S. H. P. CIRC



**L.A PLAN FOR  
STRENGTHENING AND WIDENING (TO TWO LANES) OF  
PANAGAR - DUBRAJPUR - NALHATI - MOREGRAM ROAD  
P.S.- ILLAMBAZAR DIST. BIRBHUM.**

SCALE 330'-0" = 1"

**NOTES:-**

1. LAND ALREADY ACQUIRED
2. LAND TO BE ACQUIRED
3. DIMENSION TAKEN FROM CENTRE LINE.

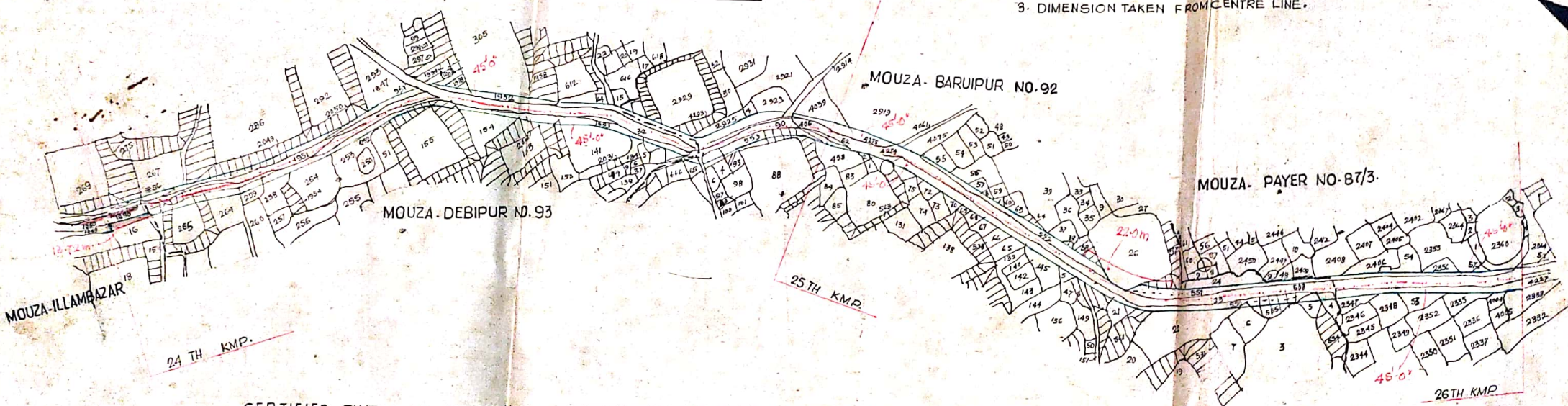

CERTIFIED THAT I AM PERSONALLY SATISFIED WITH THE ROAD ALIGNMENT WHICH HAS BEEN SELECTED KEEPING IN VIEW THE INTERESTS OF FAST TRAFFIC CONSISTENT WITH THE MINIMUM ACQUISITION OF VALUABLE LAND AND HOMESTEADS. HOMESTEADS AND LAND PROPOSED TO BE ACQUIRED ARE ESSENTIAL FOR THE CONSTRUCTION/IMPROVEMENT OF THE ROAD AND CANNOT BE AVOIDED.

*P. Sarkar*  
P. SARKAR.  
DRAWN BY

*A. K. Dam*  
ASSTT. ENGINEER  
HIGHWAY SURVEY DIVISION-I.

(A. K. DAM)  
EXECUTIVE ENGINEER

*S. H. P. Circle*  
SUPDT. ENGINEER

HIGHWAY SURVEY DIVISION-I. HIGHWAY SURVEY DIVISION-I S.H.P. CIRCLE