

PLAN
 OF LAND TO BE FURTHER ACQUIRED PERMANENTLY
 FOR EXCAVATION OF DY. 8 EX. KOPAI SOUTH MAIN CANAL
 IN CONNECTION WITH MAYURAKSHI PROJECT IN MOUZA-
 KURUMBA J.L. 58 IN P.S. LABPUR; DIST. BIRBHUM
 SCALE: -330'21" INCH.

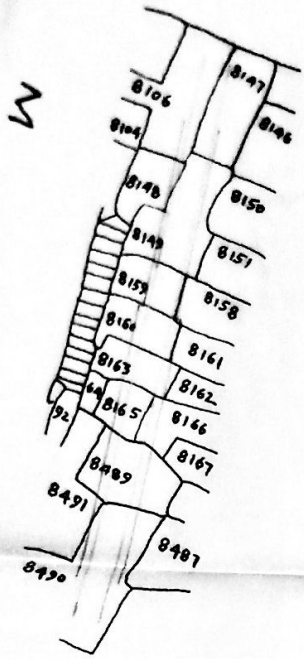

- REFERENCE:-
1. LAND ALREADY ACQUIRED PERMANENTLY:-
 2. LAND TO BE FURTHER ACQUIRED PERMANENTLY:-

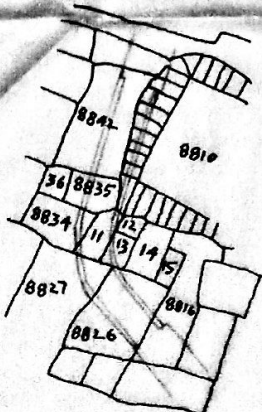

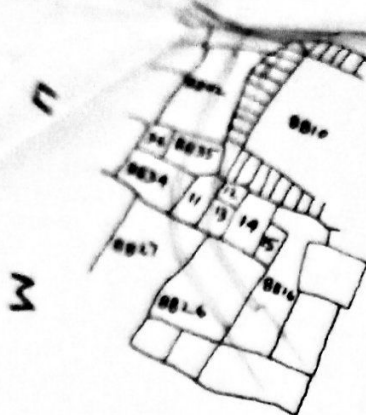

U. L. No. 58.

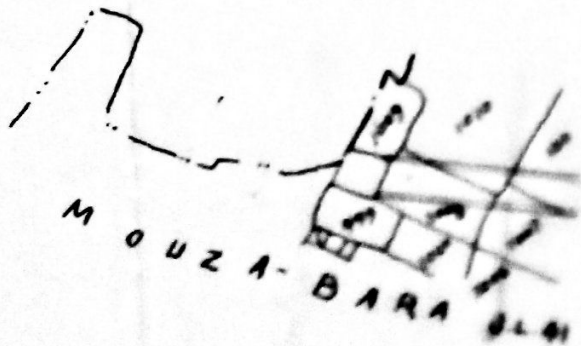

TRADED BY:- *Shanija*

CKD. BY:-

KSD.

ADDL. L. A. O. SERI, BIRBHUM