

111
17/65-66

LAND ACQUISITION PLAN FOR PURANDARPUR-RANGAIPUR V.R.
P. S. SURI. DIST.-BIRBHUM.

SCALE:- 16" = 1 MILE.



MOUZA:- DHALTIKRI. J.L. No. 55



LE Post.

MOUZA:- GOALGRAM. J.L. No. 54

3RD MILE POST.

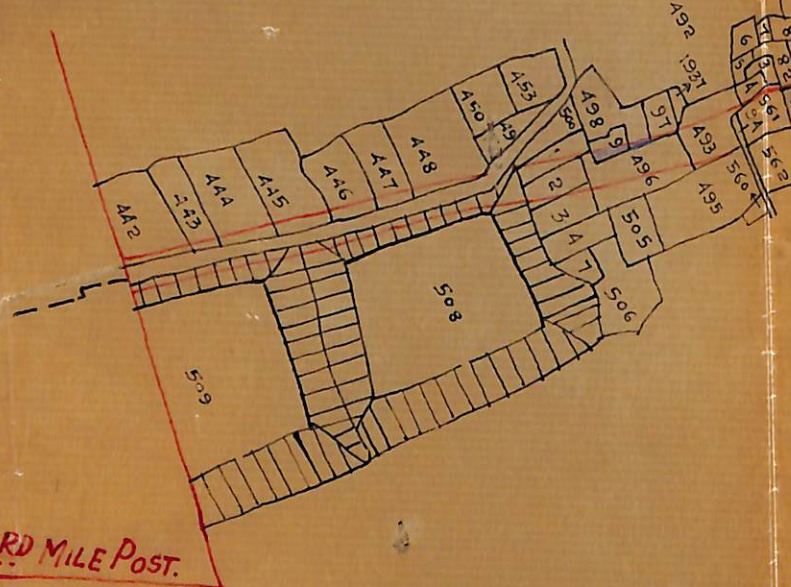

MOUZA:- BANSRA. J.L. No. 51.

- Ref.
- i) Land Proposed For Acquisition Shown Thus.
 - ii) A Charitable Institution On G.S. Plot No 466 Of Bansra
 - iii) Kutchha & Pucca Structures affected by the alignment
- Shown Thus.

Traced By.
P.K. Roy.

CKD. BY.

Arjun
14/1/65
1/65

[Signature]
(H. Ghosal.)
Add. L.A. Collector.
Birbhum.