

PLAN OF LAND TO BE ACQUIRED PERMANENTLY FOR THE MINOR NO. 1 FROM THE TAIL END OF EX. K.S.M.C. IN MOUZA-KHANRERA J.L.No.89 MASADDA J.L.No.58 YON NABAGRAM J.L.No.59; P.S. BHARATPURA, DIST. MURSHIDABAD SCALE:- 3/30"=1"

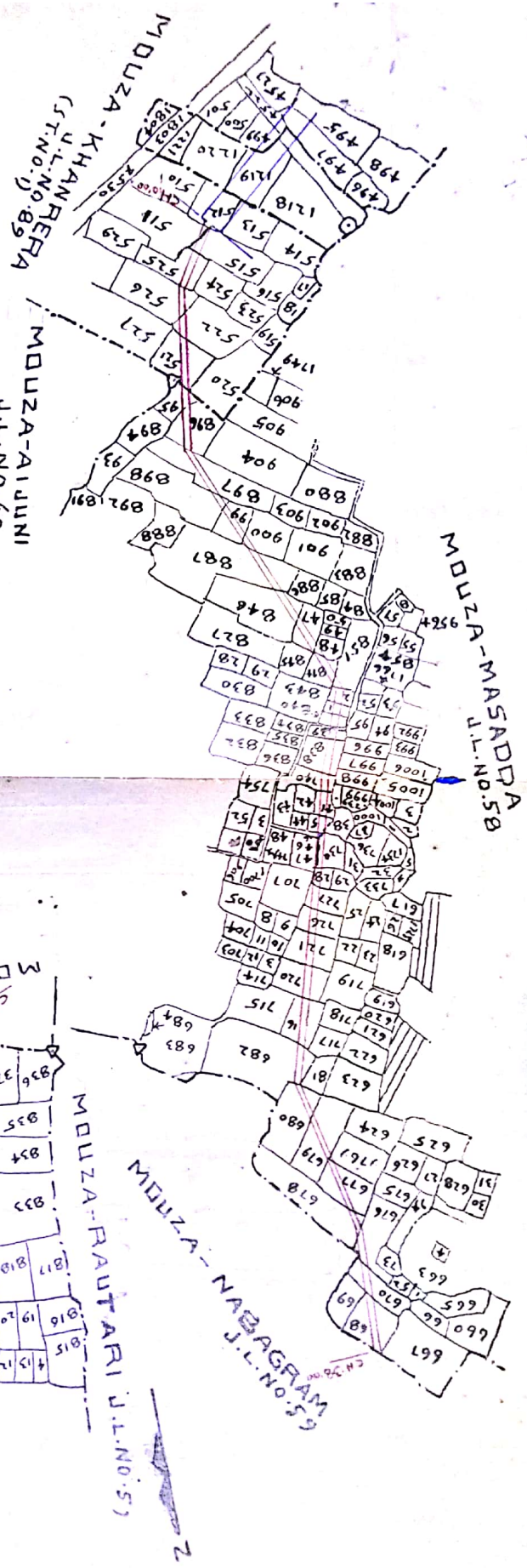

REF:-
 LAND ALREADY ACQUIRED SHOWN THUS: ---
 LAND TO BE ACQUIRED SHOWN THUS: ---
 VESTED LAND SHOWN THUS: ---

MOUZA AND J.L. NO.	P.S. AND DIST.	G.S. PLOT NO.	AREA ACYR
KHANRERA No.89 (ST.1)	BHARATPURA MURSHIDABAD	511-512, 515, 521-522, 525 AND 526 - IN PART.	0.25 ACYR
MASADDAN No.58	DD	667, 668, 670, 674, 677, 678, 679, 680, 681, 681L, 716, 717, 721, 726, 727, 728, 730, 732, 741, 745, 747, 838, 839, 840, 841, 844L, 844, 846, 847, 848, 851, 887, 895, 896, 897, 898 AND 677/1161 - IN PART.	1.52 ACYR
NABAGRAM No.59	DD	815, 816, 818, 819, 830, 831, 839, 842, 845 AND 830/976 - IN PART.	0.40 ACYR

SCHEDULE OF LAND



ACCEPTED BY:- Shamayin

CKD BY:

SPL. L.A. OFFICER BIRBHUM