

LAND ACQUISITION PLAN FOR KANKALITALA-LABUR SECTION OF BOLPUR GUNUTIA ROAD

P. S. LABPUR



DISTRICT - BIRBHUM

SCALE - 1" = 4000'

OR - 16" = 1 MILE

26/75-76

Notes:-

Lands not to be acquired shown thus:   
Lands to be acquired shown thus: 

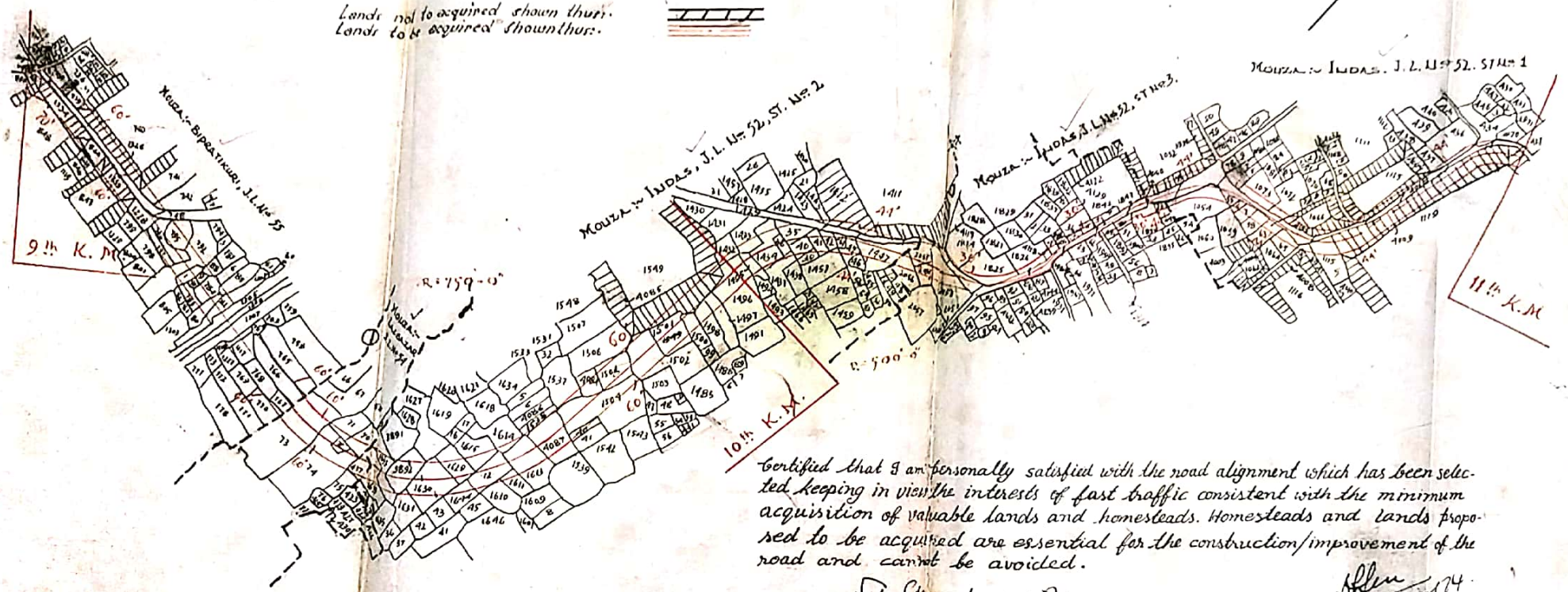

I am personally satisfied with the road alignment which has been selected keeping in view the interests of fast traffic consistent with the minimum acquisition of valuable lands and homesteads. Homesteads and lands proposed to be acquired are essential for the construction/improvement of the road and cannot be avoided.

TRACED BY, S. Bomerje

ASSISTANT ENGINEER  
SURVEY DIVISION No 1,

EXECUTIVE ENGINEER  
SURVEY DIVISION No 1

SUPERINTENDING ENGINEER  
ROAD PLANNING CIRCLE.

LAND ACQUISITION PLAN FOR KANKALITALA-LARPUR.

SECTION OF BOLPUR GUNJITA ROAD.

P. S. BOLPUR . DIST :- BIRBHUM



SCALE :- 1" = 4000

OR 16" = 1 MILE.

20/75-76

812  
11-12  
74  
10

NOTE :-

LAND NOT TO BE ACQUIRED SHOWN THUS...   
 LAND TO BE ACQUIRED SHOWN THUS... 

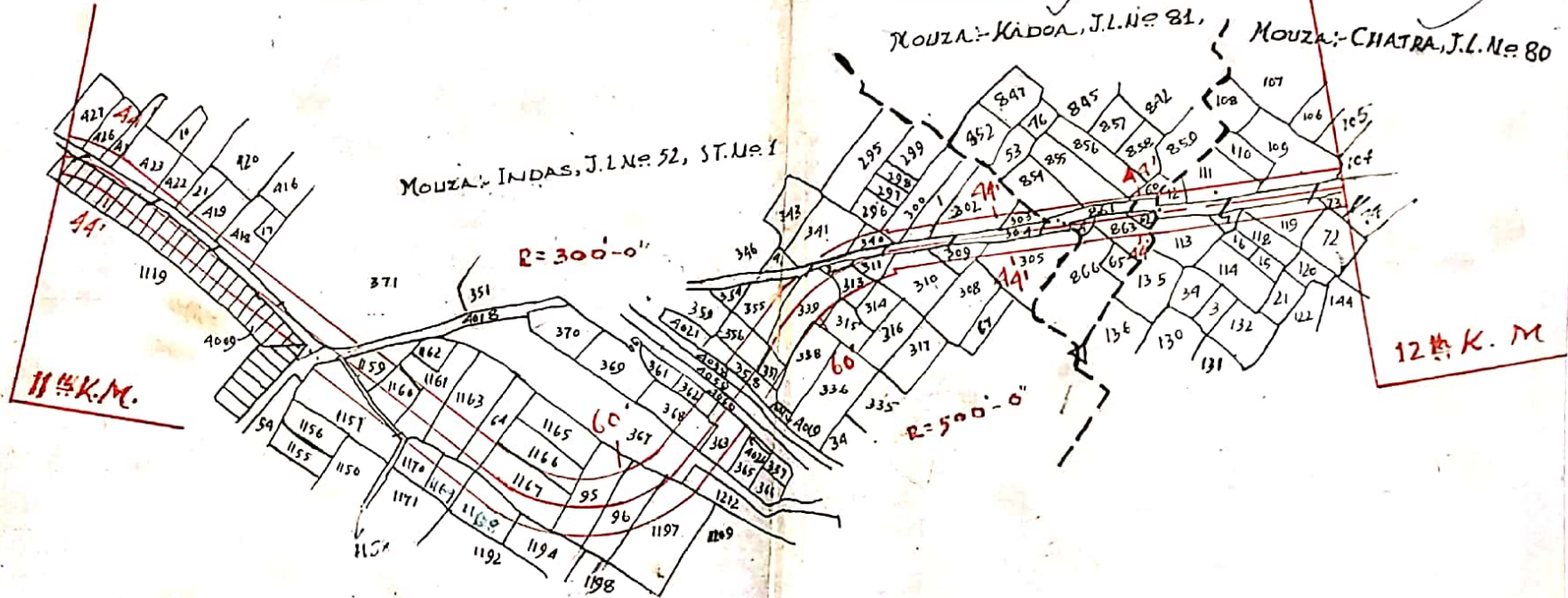

I certified that I am personally satisfied with the road alignment which has been selected keeping in view the interests of fast traffic consistent with the minimum acquisition of valuable lands and homesteads. Homesteads and lands proposed to be acquired are essential for the construction/improvement of the road and cannot be avoided.

ASSISTANT ENGINEER,  
SURVEY DIVISION No 1

TRACED BY. S. Banerjee.

*D. Chandra*  
14/10/74  
EXECUTIVE ENGINEER  
SURVEY DIVISION No 1

*Chandra*  
14.10.74.

*J. K. M.*  
16/10/74  
SUPERINTENDING ENGINEER.  
ROAD PLANNING CIRCLE.



# REVISED LAND ACQUISITION PLAN FOR KANKALITALA-LABPUR SECTION OF BOLPUR-GUMTITA ROAD.

P. S. LAVPUR.

DISTRICT:- BIRBHUM.

SCALE 1: 4000

NOTES:-

- 1) REVISED ALIGNMENT SHOWN THUS..... 
- 2) PREVIOUS ALIGNMENT SHOWN THUS..... 
- 3) LAND NOT TO BE ACQUIRED SHOWN THUS..... 



*S. Biswas*  
11.5.17

ASSISTANT ENGINEER  
HIGHWAY SURVEY DIV. No 1

*[Signature]*  
EXECUTIVE ENGINEER 12.5.17  
HIGHWAY SURVEY DIV. No 1

*[Signature]*  
12.5.17  
SUPERINTENDING ENGINEER  
STATE HIGHWAY PLANNING OFFICE