





SHOWING THE LAND PROPOSED FOR ACQUISITION
FOR MULUK-KALITALA DANGA MODEL VILLAGE IN MOUZA
MULUK J.L. 121 IN P.S. BOLPUR, DIST. BIRBHUM
SCALE: 330"=1"

LAND TO BE ACQUIRED SHOWN THUS: 
C.S. PLOT 201 - IN PART TO BE ACQUIRED.
AREA MORE OR LESS - 36.70 ACRES.

HOMESTEAD LAND SHOWN THUS: 
PADDY LAND SHOWN THUS: 

REVISED LINE OF ALIGNMENT SHOWN THUS: 

MOUZA - GAYESPUR J.L. No. 122

MOUZA - DAKSHIN-NARAYANPUR
J.L. No. 120

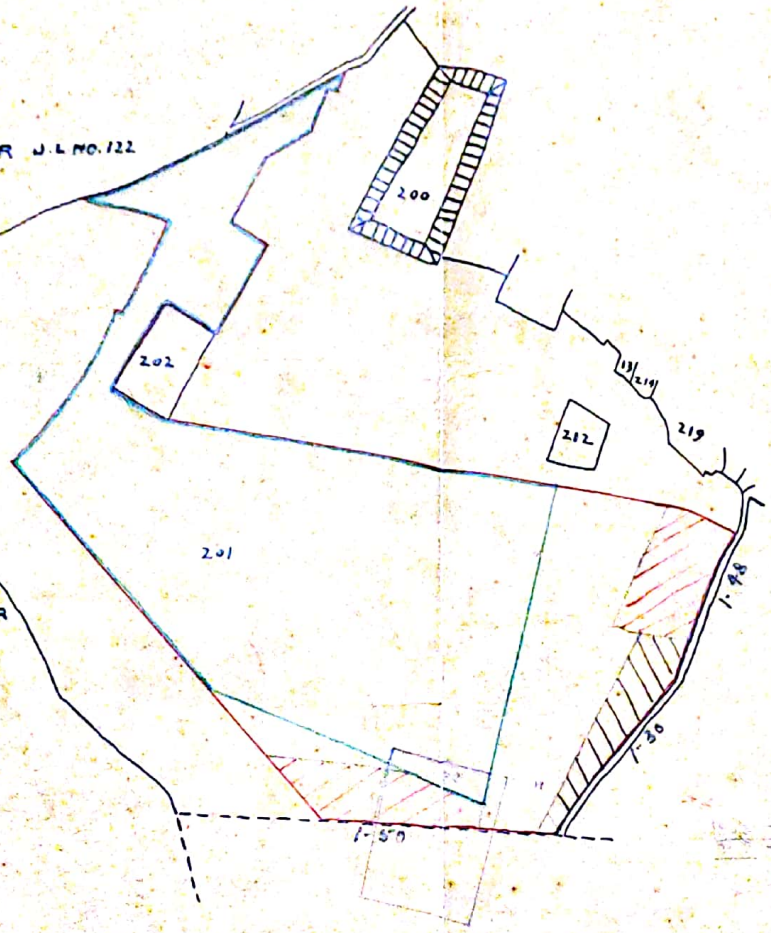

CKD. BY.

Sudh
26/11/50
KGD.

ADDL. LAND ACQUISITION COLLECTOR
BIRBHUM

[Signature]

TRACED BY: *[Signature]*

PLAN OF LAND ACQUIRED FOR CONSTRUCTION OF MULUK KALITALA DANGA MODEL VILLAGE IN MOUZA-MULUK J.L.No.121 IN P.S. BOLPUR; DIST. BIRBHUM

SCALE: - 330/1"

REF: - LAND ACQUIRED SHOWN THUS: - 

179



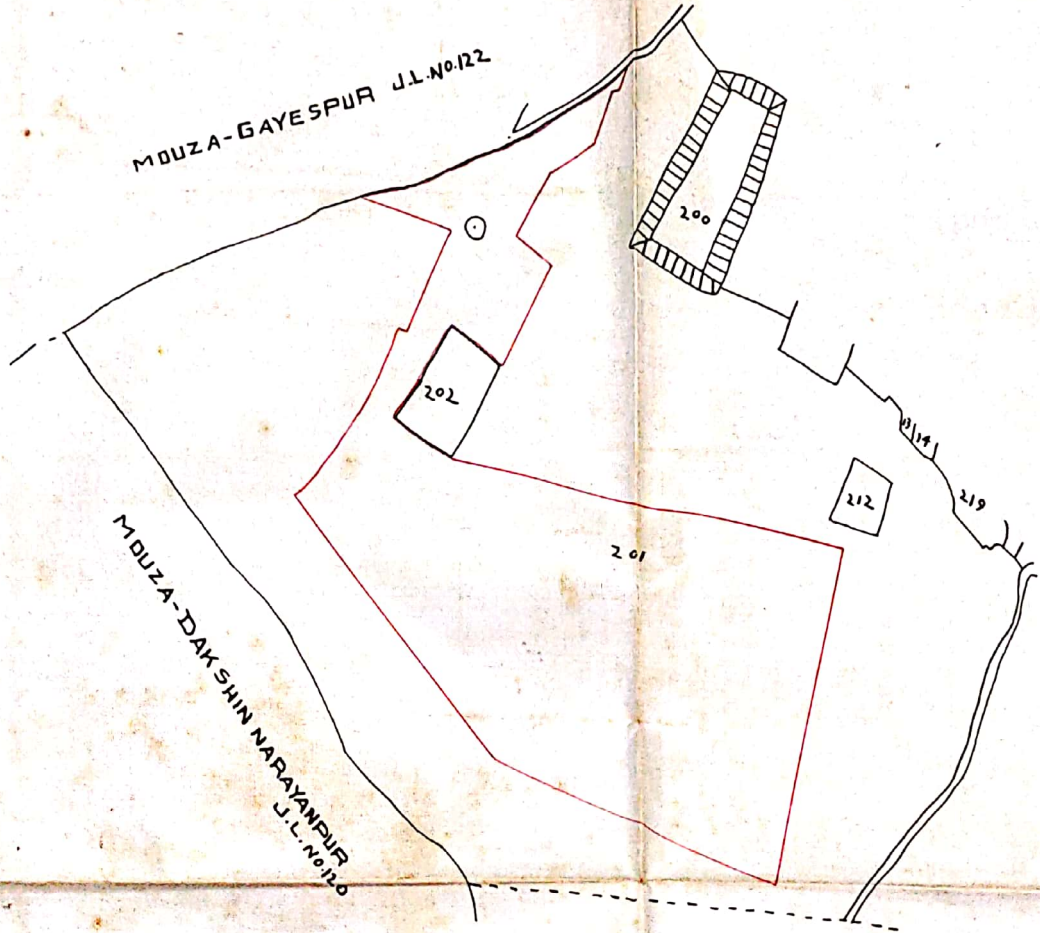

SCHEDULE OF LANDS

MOUZA	J.L.No.	P.S.	DIST.	C.S. PLOTS	AREA
MULUK	121	BOLPUR	BIRBHUM	201 - IN PART	24.12 ACRES



CERTIFIED THAT THE LANDS IN THIS PLAN WERE DULY ACQUIRED UNDER THE PROVISIONS OF WEST BENGAL LAND (REQUISITION AND ACQUISITION) ACT II OF 1948 AND UNDER NOTICE NO. 21322 L.A.(P.W) DATED THE 15TH NOVEMBER, 1957 PUBLISHED AT PAGE 4116 PART I OF THE CALCUTTA GAZETTE OF THE 21ST NOVEMBER, 1957 READ WITH CANCELLATION NOTIFICATION NO. 13998 L.A.(P.W) DATED THE 22ND JULY, 1958 PUBLISHED AT PAGE 2396 PART I OF THE CALCUTTA GAZETTE OF THE 31ST JULY, 1958 AND IN PROCEEDING NO. 22 OF 1957-58 AND THAT UNDER SECTION 4(1A) OF THE ACT THEY HAVE VESTED ABSOLUTELY IN THE IRRIGATION DEVELOPMENT DEPARTMENT, RAJBHAVAN OF THE STATE GOVERNMENT FROM 21ST NOVEMBER, 1957

CKD. BY.

4/1/60

TRACED BY: - 

KGO.

SPL. L.A. COLLECTOR
BIRBHUM

(P.C. Banerjee)
COLLECTOR
BIRBHUM