

PLAN OF LAND TO BE ACQUIRED PERMANENTLY FOR 33/11 K.V. SUB-STATION OF W. B. S. E. B. IN MOUZA - BAKUL - J.L. NO - 123. & SARPARAJPUR J.L. NO - 102. P.S. - LAVPUR, - DIST. - BIRBHUM. - SCALE :- 330'0" = 1".



LAND TO BE ACQUIRED SHOWN THUS :-



LAND to be transferred >> >>

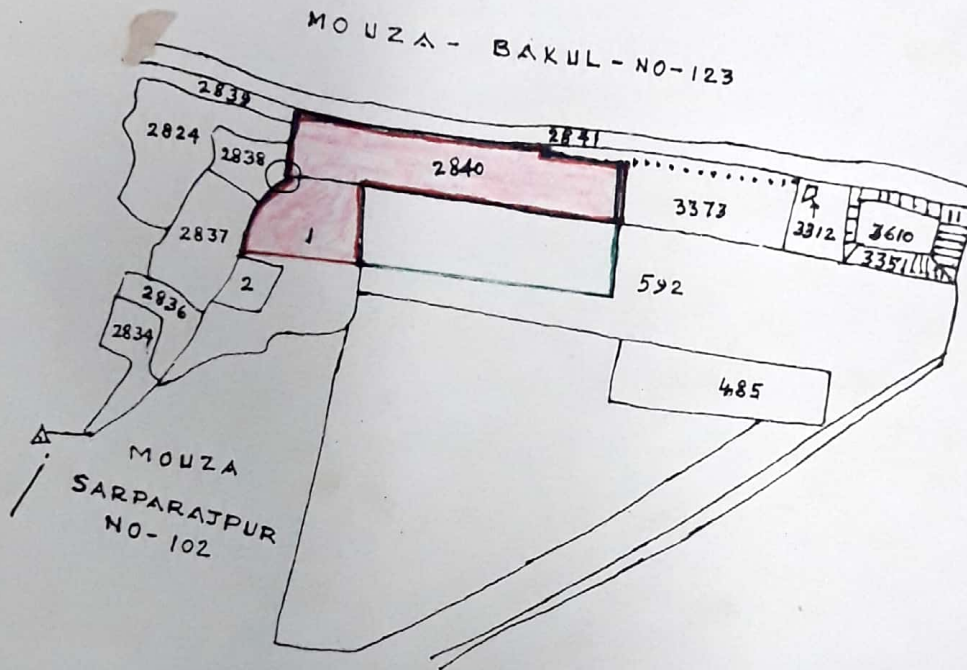

SCHEDULE OF LANDS.

MOUZA & J.L. NO.	P.S.	DIST.	RS./L.R. PLOTS.	AREA
BAKUL. - 123	LAVPUR	BIRBHUM.	INFULL: - 2840. INPART: - 2840/3373	2.32 <u>Acres</u>
SARPARAJPUR-102	DO.	DO.	INPART - 1.	OR 0.9389 Hectares

[Signature] 25/95
SPL. L.A. Officer. Addl. District Magistrate.
Birbhum. Birbhum.

DRAWN BY:- *[Signature]* verified by:- *[Signature]*
27.4.94 2/5/95