

Plan Of land to be acquired Permanently for minor With Water Course from

550 (left) Of D.B.M/2/3 in mouza - Mollarpur - 22 P.S - Mayureswar - D.

Scale - 330' 0" = 1"

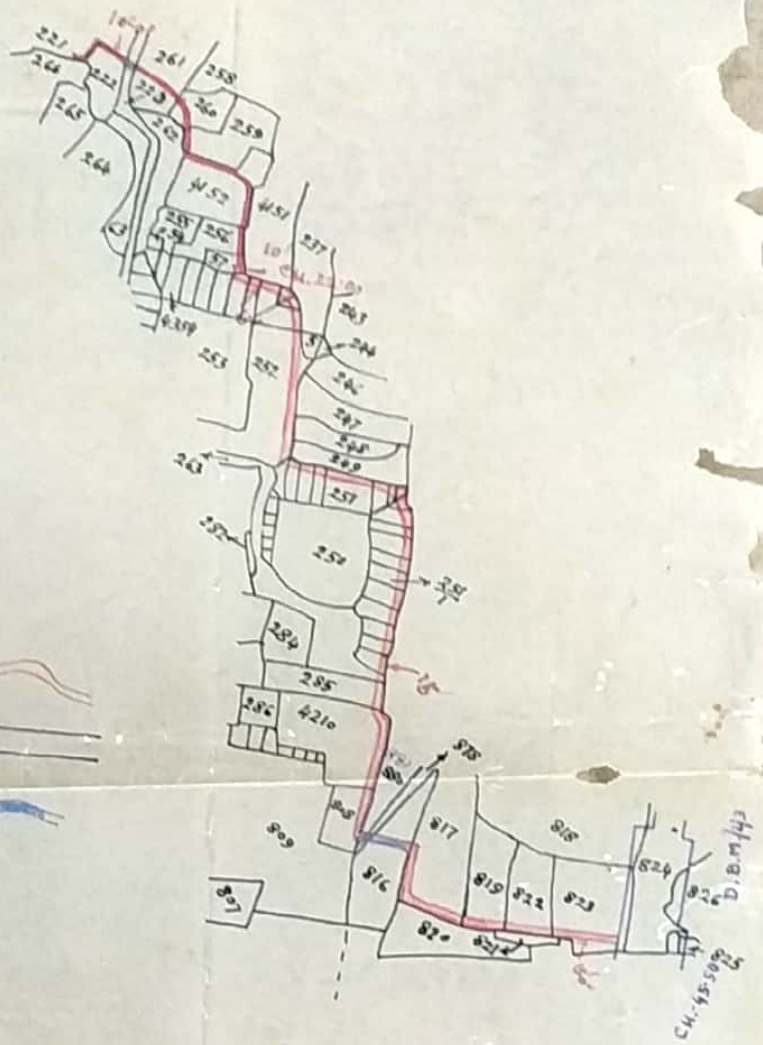

Ref

- 1. Land to be acquired Shown thus: -
- 2. Land already " " " " " " " " -
- 3. Vested lands " " " " " " " " -

Schedule Of Lands

MOUZA - J.L. NO.	P. S.	District	C. S. Plots	Area
<u>Mollarpur - 22.</u>	<u>Mayureswar</u>	<u>Birbhum.</u>	221, 222, 251, 252, 256, 257, 259 260, 261, 285, 808, 817, 819, 822, 823 258/4152, 809/4210, 253/4354.	0 82 acre.

Traced by:-   
C. Gupta  
S/Man  
21.2.68

CKD. by:-   
J. Kumar  
Surveyor  
31.5.68

Spl. L. A. Collector  
Birbhum

Confirmed by  
B. S. S. S.  
21.5.68