

CASE NO. 3/90-91

PLAN OF LAND TO BE ACQUIRED FOR CONSTRUCTION OF DUBRAJPUR MOLLARPUR ROAD FROM 65.738 K.M.P TO 72.388 K.M.P FOR SURI BYE-PASS ROAD IN CONNECTION WITH A. D. B PROJECT (SEC. FROM 65.738 K.M.P. TO 67 K.M.P) IN MOUZA-ABDARPUR. J.L.No.97 & ANANDAPUR. J.L.No.103 P.S.-SURI IN THE DISTRICT OF BIRBHUM.

SCALE-330' FT = 1" INCH.

REP:-
 LAND TO BE ACQUIRED SHOWN THUS--
 LAND NOT TO BE ACQD. 22 22 --
 VESTED LAND NOT TO BE ACQD. 22 22 --
 HOME-STEAD LAND NOT TO BE ACQD. 22 22 --
 LAND NOT TO BE ACQD. FOR DEV. DEPH. OF
 Sch. C & Tsd. Trib. Shown --

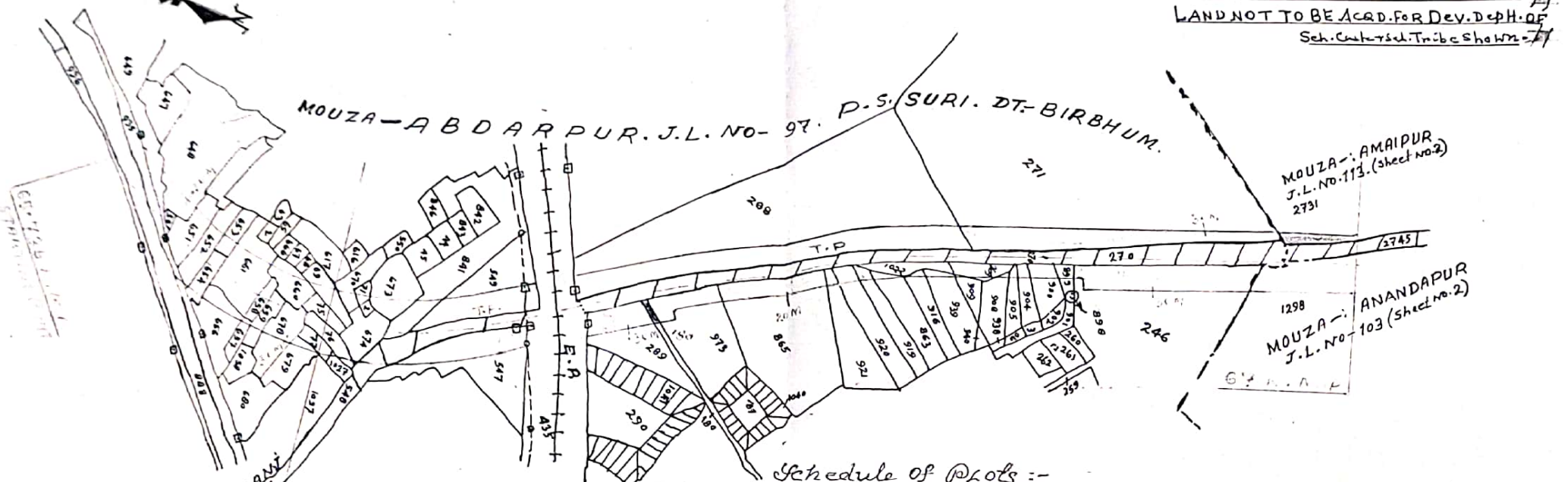

Schedule of Plots :-

| MOUZA & J.L. NO. | P.S. | D.T. | R. S. PLOT NOS. IN FULL AND PART. | AREA | TOTAL AREA |
|------------------|------|----------|---|----------------|----------------|
| ABDARPUR-97 | SURI | BIRBHUM. | 650, 658, 672, 674, 675 & 261/1022. IN FULL | 8.64 ACRES. | 9.38 ACRES. |
| | | | 269, 288, 289, 547, 549, 648, 649, 651, 652, 653, 654, 656, 657, 659, 660, 661, 669, 261/921, 269/939, 670, 671, 673, 676, 677, 678, 679, 549/841, 269/863, 269/899, 269/900, 269/904, 269/905, 269/908, 269/909, 269/916, 269/919, 269/920, 269/973 & 677/1027. IN PART. | | |
| ANANDAPUR-103 | | | 1298 IN PART. | .74 OF AN ACRE | [3.7938 HECTS] |

DRAWN BY: *P. K. Ghosh*
 25/9/92.

VERIFIED *P. Samal*
 21/10/92
 Surveyor & S.A.E.

ADDL. L.A. OFFICER,
 BIRBHUM.

ADDL. DIST. MAGISTRATE,
 BIRBHUM.