

**PLAN SHOWING LANDS TO BE ACQUIRED IN FAVOUR OF VISVA-BHARATI  
FOR THE PURPOSE OF  
GEOGRAPHICAL INTEGRATION OF VISVA-BHARATI CAMPUS AS WELL AS  
FOR DIVERSION OF ROAD FOR SAVING AND PROTECTING  
THE AMBIENCE OF SANTINIKETAN ASHRAM**

SCALE - 1" = 330'-0"

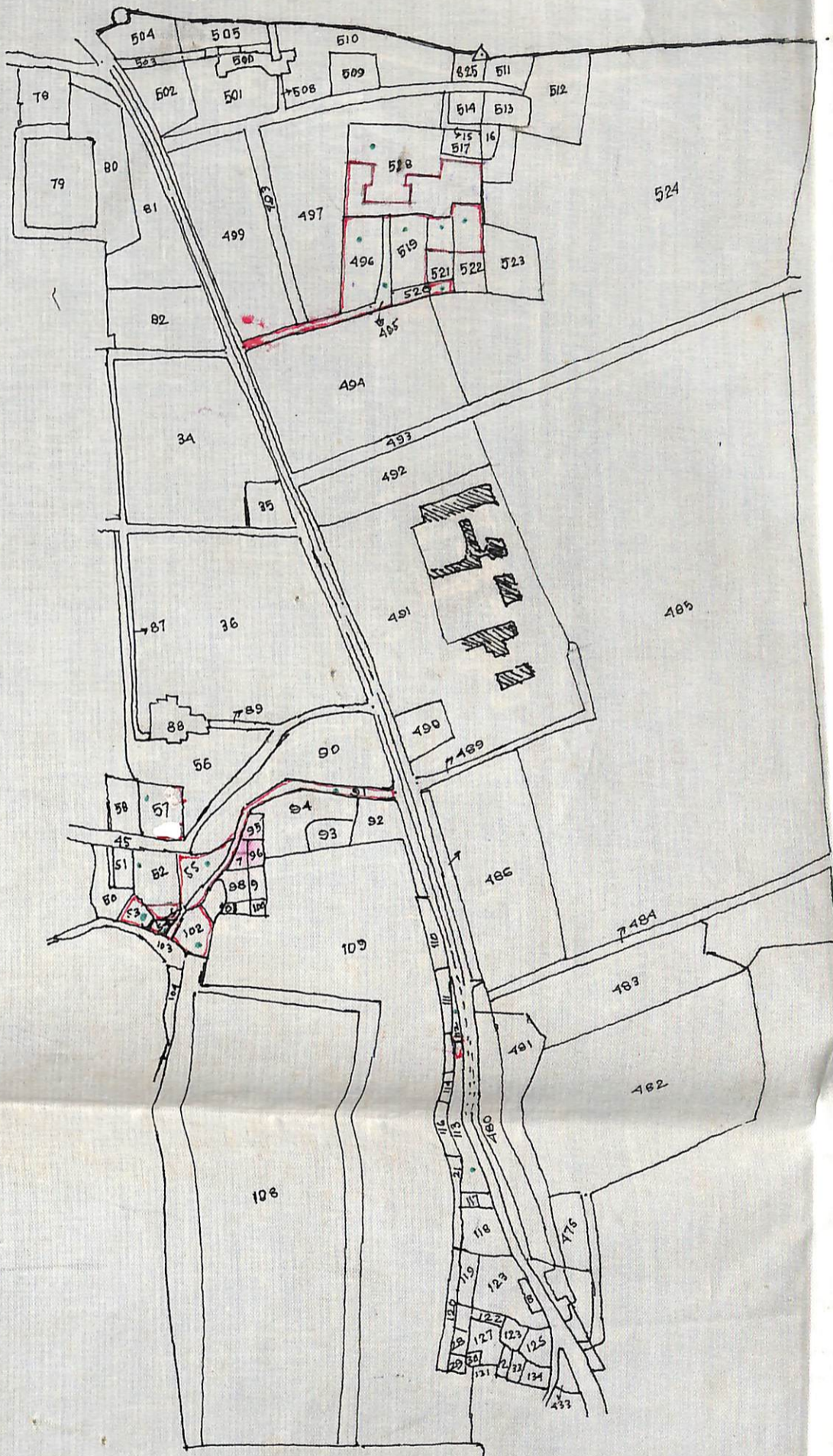

REFERENCE

LAND PROPOSED FOR ACQUISITION HAS SHOWN THIS:-

SCHEDULE OF LAND

DISTRICT - BIRBHUM, P.S. - BOLPUR, MOUZA - BOLPUR, J. L. NO. 99  
L.R. PLOT NO. 52, 53, 54, 55, 57, 91, 102, 112, 113, 495, 496, 518, 520, 521, & 522.  
TOTAL AREA MORE OR LESS 2.8566 ACRES.

DRAWN BY - *[Signature]*

CHECKED BY - *[Signature]*  
Junior Engineer - I (Civil)  
Estate Office

*[Signature]*  
Dy. Registrar  
in-charge, Estate  
DEPUTY REGISTRAR  
IN-CHARGE, ESTATE  
VISVA-BHARATI  
*[Signature]*  
29/3/12  
DEPUTY REGISTRAR  
(DEVELOPMENT)  
VISVA-BHARATI  
in-charge, Legal Cell  
Visva-Bharati

*[Signature]*  
REGISTRAR  
VISVA-BHARATI  
Karma-Sachiva  
(Registrar)  
Visva-Bharati