

PLAN OF LAND TO BE ACQD. PERMANENTLY FOR RESER-
Chrimating Plant and Staff Quarters in The Eastern Zone,
VOIR SITE OF RAMPURHAT IN CONNECTION WITH
W/S SCHEME IN MOUZA RAMPURHAT No. 77 (Part 1)
— P.S. RAMPURHAT, DT. BIRBHUM. —
SCALE - 16" = 1 MILE

REF

- 1. Land to be acquired Permanently *Shan Kus* ■
- 2. Land already acquired in L.A. Plan No. 28/80-81 ■

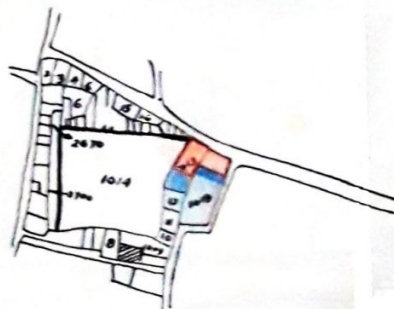

SCHEDULE OF LANDS.

Mouza	S. No.	P. S.	District	L. S. Plots in part	Area
Rampurhat (Part-1)	77	Rampurhat	Birbhum	1013 & 1018.	0.135 ganna

S. A. B. B.
9.6.81
PREPARED BY.

3047/77
 Addl. L. A. Officer
 Birbhum

checked
B. J. S.
 29.6.81
 Surveyor S.A.B. (C.P. & H.)