

# LAND ACQUISITION PROPOSAL FOR CONSTRUCTION OF ROB AT KM 338.000 (SURI) OF NH 60 IN BIRBHUM DISTRICT, WEST BENGAL

Mouza - Amritapur

J.L. No - 95

Sheet No - 01

P.S. - Suri

District - Birbhum

Chainage from 337+703 Km to 339+046 Km

Mouza - Abdarpur

J.L. No - 97

P.S. - Suri

District - Birbhum

Length - 1.343 m

Scale: 16" = 1 Mile

Proposal No: 01

**LEGEND :-**  
 --- PROP. CL  
 --- PROP. ROW



CERTIFIED THAT, I AM PERSONALLY SATISFIED WITH THE ROAD ALIGNMENT WHICH HAS BEEN SELECTED KEEPING IN VIEW THE INTEREST OF FAST MOVING TRAFFIC ALONG WITH MINIMUM ACQUISITION OF VALUABLE LAND AND HOMESTEADS WHICH ARE ESSENTIAL TO BE ACQUIRED FOR THE CONSTRUCTION / IMPROVEMENT OF THE ROAD AND CAN NOT BE AVOIDED.

*[Signature]*  
 Assistant Engineer  
 NH Planning & Design Division-II  
 P.W. (Roads) Directorate

*[Signature]*  
 Executive Engineer  
 NH Planning & Design Division-II  
 P.W. (Roads) Directorate

*[Signature]*  
 Superintending Engineer  
 NH Planning & Design Circle  
 P.W. (Roads) Directorate

CLIENT:-

MINISTRY OF ROAD  
 TRANSPORT & HIGHWAYS  
 GOVERNMENT OF INDIA



Chaitanya Projects Consultancy Pvt. Ltd.  
 C-5, 2ND FLOOR, R.K.TOWER, PLOT NO.- 21-22,  
 SECTOR- 4, VAISHALI, GHAZIABAD  
 PH.: 0120-4120472, FAX: 0120-4110472

PROJECT :-

CONSTRUCTION OF ROB AND ITS APPROACHES IN LIEU OF LEVEL  
 CROSSING NO. 21SPL/UE AT KM.338.000 OF NH-60 IN THE DISTRICT OF  
 BIRBHUM, WEST BENGAL.

SCALE:-

1:3960  
 16" = 1 Mile

DWG TITLE :-

LAND ACQUISITION PLAN  
 LC GATE NO.21 SPL  
 AT KM. 338.000

DRAWING No.:

P-109/L.C. NO. 21 SPL/EA PLAN-01

PREPARED BY  
 APARNA

DESIGNED BY  
 HIRRAJ

APPROVED BY  
 S.K. BHARJA

ACTUAL SHEET SIZE - A3



# LAND ACQUISITION PROPOSAL FOR CONSTRUCTION OF ROB AT KM 338.000 (SURI) OF NH 60 IN BIRBHUM DISTRICT, WEST BENGAL

Mouza - Abdarpur J.L. No - 97

P.S. - Suri District - Birbhum

Chainage from 337+936 Km to 339+046 Km  
Length - 1110 m

LEGEND :-  
PROP. CL  
PROP. ROW  
EX. ROW



CERTIFIED THAT, I AM PERSONALLY SATISFIED WITH THE ROAD ALIGNMENT WHICH HAS BEEN SELECTED KEEPING IN VIEW THE INTEREST OF FAST MOVING TRAFFIC ALONG WITH MINIMUM ACQUISITION OF VALUABLE LAND AND HOMESTEADS WHICH ARE ESSENTIAL TO BE ACQUIRED FOR THE CONSTRUCTION / IMPROVEMENT OF THE ROAD AND CAN NOT BE AVOIDED.

*[Signature]*

Basic Grade Surveyor  
NH Planning & Design Division-II  
P.W. (Roads) Directorate

*[Signature]*

Junior Engineer  
NH Planning & Design Division-II  
P.W. (Roads) Directorate

*[Signature]*

Assistant Engineer  
NH Planning & Design Division-II  
P.W. (Roads) Directorate

*[Signature]*

Executive Engineer  
NH Planning & Design Division-II  
P.W. (Roads) Directorate

*[Signature]*

Superintending Engineer  
NH Planning & Design Circle  
P.W. (Roads) Directorate

CLIENT:-

MINISTRY OF ROAD  
TRANSPORT & HIGHWAYS  
GOVERNMENT OF INDIA



Chaitanya Projects Consultancy Pvt. Ltd.  
C-5, 2ND FLOOR, R.K.TOWER, PLOT NO. - 21-22,  
SECTOR- 4, VAISHALI, GHAZIABAD  
PH.: 0120- 4120472, FAX: 0120-4110472

PROJECT :-

CONSTRUCTION OF ROB AND ITS APPROACHES IN LIEU OF LEVEL  
CROSSING NO. 21/SPL/E AT KM.338.000 OF NH-60 IN THE DISTRICT OF  
BIRBHUM, WEST BENGAL.

SCALE:-  
1:3980  
1" = 1 Mile

DWG TITLE :-

LAND ACQUISITION PLAN  
LC GATE NO.21/ SPL  
AT KM. 338.000

DRAWING No :  
P-109/L.C. NO. 21 SPL/E/LA PLAN-02

REVISION: R2  
PREPARED BY: P.K.SHUKLA  
DESIGNED BY: NEERAJ  
APPROVED BY: S.K.SINHA

ACTUAL SHEET SIZE - A3

# L.A. PLAN FOR SURI BYE-PASS UNDER THE PROJECT "WIDENING OF ROAD FROM PANAGAR-DUBRAJPUR-NALHATI-MOREGRAM A.D.B. PACKAGE II."

P.S. - SURI, DT. - BIRBHUM.

SCALE - 1: 4000

NOTE:-

LAND TO BE ACQUIRED SHOWN THUS ---

LAND NOT TO BE " " " ---

R - 360M  
 S - 68° 35'  
 TS - 272.5M  
 LS - 59M  
 S - 0.4M  
 QS - 4° 42'  
 C - 7%  
 AS - 58° 6'  
 LC - 368.2  
 ES - 74.7  
 K - 29.4934

MOUZA - ABDARPUR  
 J.L. NO 97

MOUZA - AMAIPUR  
 J.L. NO. 113, ST. NO. 2

MOUZA - ANADAPUR  
 J.L. NO. 103  
 SIT. NO. 2

CERTIFIED THAT I AM PERSONALLY SATISFIED WITH THE ROAD ALIGNMENT WHICH HAS BEEN  
 SELECTED KEEPING IN VIEW THE INTEREST OF FAST TRAFFIC CONSISTENT WITH THE MINIMUM  
 ACQUISITION OF VALUABLE LAND & HOMESTEADS. HOMESTEADS & LAND PROPOSED TO BE ACQUIRED  
 ARE ESSENTIAL FOR THE CONSTRUCTION/IMPROVEMENT OF THE ROAD & CANNOT BE AVOIDED.

Assistant Engineer  
 HIGHWAY SURVEY DIVN. NO. II

Executive Engineer  
 HIGHWAY SURVEY DN. NO. III

Superintending Engineer  
 STATE HIGHWAY PLANNING CIRCLE



# LAND ACQUISITION PROPOSAL FOR CONSTRUCTION OF ROB AT KM 338.000 (SURI) OF NH 60 IN BIRBHUM DISTRICT, WEST BENGAL

Mouza - Abdarpur  
Scale: 16" = 1 Mile  
Proposal No: 01

J.L. No - 97

P.S. - Suri

District - Birbhum

Chainage from 337+703 Km to 339+046 Km  
Length - 1.343 m

**LEGEND :-**  

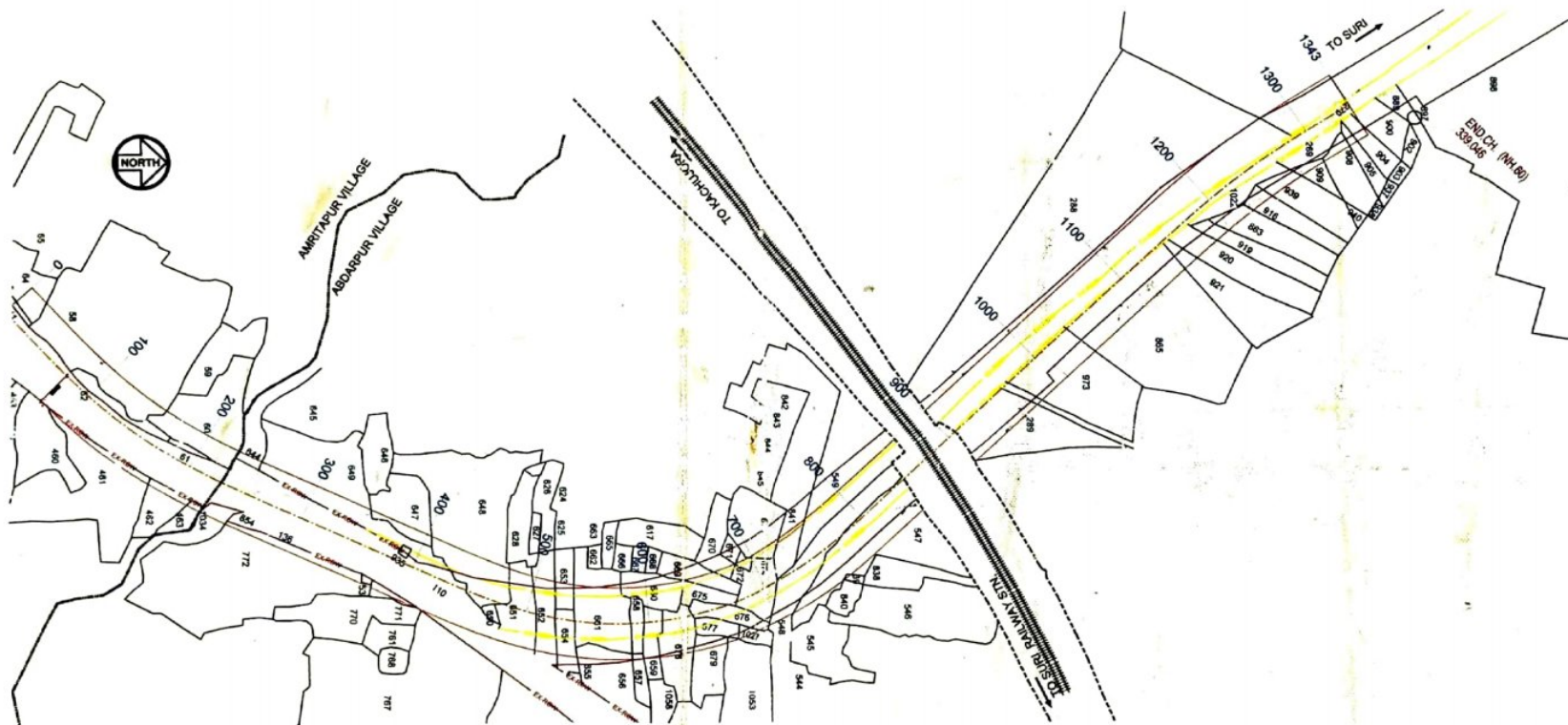
 PROP. CL  
 PROP. ROW  
 EX. ROW  
 EX. ROW BEFORE 1988



CERTIFIED THAT, I AM PERSONALLY SATISFIED WITH THE ROAD ALIGNMENT WHICH HAS BEEN SELECTED KEEPING IN VIEW THE INTEREST OF FAST MOVING TRAFFIC ALONG WITH MINIMUM ACQUISITION OF VALUABLE LAND AND HOMESTEADS WHICH ARE ESSENTIAL TO BE ACQUIRED FOR THE CONSTRUCTION / IMPROVEMENT OF THE ROAD AND CAN NOT BE AVOIDED.

  
 Assistant Engineer  
 NH Planning & Design Division-II  
 P.W. (Roads) Directorate

  
 Executive Engineer  
 NH Planning & Design Division-II  
 P.W. (Roads) Directorate

  
 Superintending Engineer  
 NH Planning & Design Circle  
 P.W. (Roads) Directorate

CLIENT:-

MINISTRY OF ROAD  
TRANSPORT & HIGHWAYS  
GOVERNMENT OF INDIA



Chaitanya Projects Consultancy Pvt. Ltd.  
 C-5, 2ND FLOOR, R.K.TOWER, PLOT NO.- 21-22,  
 SECTOR- 4, VAISHALI, GHAZIABAD  
 PH.: 0120- 4120472, FAX: 0120-4110472

PROJECT :-

CONSTRUCTION OF ROB AND ITS APPROACHES IN LIEU OF LEVEL  
 CROSSING NO. 21SPL/E AT KM.338.000 OF NH-60 IN THE DISTRICT OF  
 BIRBHUM, WEST BENGAL

SCALE:-

1:3960  
 16" = 1 Mile

DWG TITLE :-

LAND ACQUISITION PLAN  
 LC GATE NO.21 SPL  
 AT KM. 338.000

DRAWING No :  
 P-109/L.C. NO. 21 SPL/E/LA PLAN-01

PREPARED BY  
 P.K.SHUKLA

DESIGNED BY  
 NEERAJ

APPROVED BY  
 S.K.BHAR

ACTUAL SHEET SIZE - A3

Scanned with CamScanner

Scanned with CamScanner

# LAND ACQUISITION PROPOSAL FOR CONSTRUCTION OF ROB AT KM 338.000 (SURI) OF NH 60 IN BIRBHUM DISTRICT, WEST BENGAL

Mouza - Amritapur J.L. No - 95 Sheet No - 01 P.S. - Suri District - Birbhum  
 Mouza - Abdarpur J.L. No - 97 P.S. - Suri District - Birbhum

Chainage from 337+703 Km to 339+046 Km  
 Length - 1.343 m

LEGEND :-  
 PROP. CL  
 PROP. ROW  
 EX. ROW



CERTIFIED THAT, I AM PERSONALLY SATISFIED WITH THE ROAD ALIGNMENT WHICH HAS BEEN SELECTED KEEPING IN VIEW THE INTEREST OF FAST MOVING TRAFFIC ALONG WITH MINIMUM ACQUISITION OF VALUABLE LAND AND HOMESTEADS WHICH ARE ESSENTIAL TO BE ACQUIRED FOR THE CONSTRUCTION / IMPROVEMENT OF THE ROAD AND CAN NOT BE AVOIDED.

Junior Engineer  
 NH Planning & Design Division-II  
 P.W. (Roads) Directorate

Assistant Engineer  
 NH Planning & Design Division-II  
 P.W. (Roads) Directorate

Executive Engineer  
 NH Planning & Design Division-II  
 P.W. (Roads) Directorate

Superintending Engineer  
 NH Planning & Design Circle  
 P.W. (Roads) Directorate

CLIENT:-

MINISTRY OF ROAD  
 TRANSPORT & HIGHWAYS  
 GOVERNMENT OF INDIA



Chaitanya Projects Consultancy Pvt. Ltd.  
 C-5, 2ND FLOOR, R.K.TOWER, PLOT NO.- 21-22,  
 SECTOR- 4, VAISHALI, GHAZIABAD  
 PH: 0120- 4120472, FAX: 0120-4110472

## PROJECT :-

CONSTRUCTION OF ROB AND ITS APPROACHES IN LIEU OF LEVEL CROSSING NO. 21SPL/E AT KM.338.000 OF NH-60 IN THE DISTRICT OF BIRBHUM, WEST BENGAL

SCALE:-  
 1:3960  
 16" = 1 Mile

DWG TITLE :-

LAND ACQUISITION PLAN  
 LC GATE NO.21/ SPL  
 AT KM. 338.000

DRAWING No :

P-109/L.C. NO. 21 SPL/E/LA PLAN-01

PREPARED BY  
 P.K.SHUKLA

DESIGNED BY  
 NEERAJ

APPROVED BY  
 S.K.SINHA

Scanned with CamScanner

Scanned with CamScanner



# LAND ACQUISITION PROPOSAL FOR CONSTRUCTION OF ROB AT KM 338.000 (SURI) OF NH 60 IN BIRBHUM DISTRICT, WEST BENGAL

Mouza - Abdarpur

J.L. No - 97

P.S. - Suri

District - Birbhum

Chainage from 337+703 Km to 339+046 Km

Length - 1.343 m

Scale: 16" = 1 Mile

Proposal No: 01

LEGEND :-	
	PROP. CL
	PROP. ROW
	EX. ROW
	EX. ROW BEFORE 1988



CERTIFIED THAT, I AM PERSONALLY SATISFIED WITH THE ROAD ALIGNMENT WHICH HAS BEEN SELECTED KEEPING IN VIEW THE INTEREST OF FAST MOVING TRAFFIC ALONG WITH MINIMUM ACQUISITION OF VALUABLE LAND AND HOMESTEADS WHICH ARE ESSENTIAL TO BE ACQUIRED FOR THE CONSTRUCTION / IMPROVEMENT OF THE ROAD AND CAN NOT BE AVOIDED.

*[Signature]*  
Assistant Engineer  
NH Planning & Design Division-II  
P.W. (Roads) Directorate

*[Signature]*  
Executive Engineer  
NH Planning & Design Division-II  
P.W. (Roads) Directorate

*[Signature]*  
Superintending Engineer  
NH Planning & Design Circle  
P.W. (Roads) Directorate

ET:-

MINISTRY OF ROAD  
TRANSPORT & HIGHWAYS  
GOVERNMENT OF INDIA



Chaitanya Projects Consultancy Pvt. Ltd.  
C-8, 2ND FLOOR, H.K. TOWER, PLOT NO. - 21-22,  
SECTOR- 4, VAISHALI, GHAZIABAD  
PH: 0120-4126472, FAX: 0120-4110472

## PROJECT :-

CONSTRUCTION OF ROB AND ITS APPROACHES IN LIEU OF LEVEL CROSSING NO. 21SPL/IE AT KM 338.000 OF NH-60 IN THE DISTRICT OF BIRBHUM, WEST BENGAL

## SCALE:-

1:3960  
16" = 1 Mile

## DWG TITLE :-

LAND ACQUISITION PLAN  
LC GATE NO. 21 SPL  
AT KM. 338.000

## DRAWING No:

P-109/L.C. NO. 21 SPL/EAL PL

PREPARED BY  
P.K. BHARGAVA

DESIGNED BY  
MEERAJ

AM

Scanned with CamScanner

Scanned with CamScanner

**LAND ACQUISITION PROPOSAL FOR CONSTRUCTION OF ROB AT KM 338.000 (SURI) OF NH60  
IN BIRBHUM DISTRICT, WEST BENGAL.**

**MOUZA - AMRITPUR, J.L. NO. - 95, P.S. - SURI, DIST. - BIRBHUM**

**SCALE :- 16 INCH = 1 MILE**

**Chainage From - 337 + 703 Km. to 337 + 936 Km.**

**Length - 233 M.**

**MOUZA - ABDARPUR, J.L. NO. - 97  
P.S. - SURI, DIST. - BIRBHUM.**



**LEGEND :-**

**PROPOSED ROW** .....

**EXISTING ROW** .....

**CERTIFIED THAT, I AM PERSONALLY SATISFIED WITH THE ROAD ALIGNMENT WHICH HAS BEEN SELECTED KEEPING IN VIEW THE INTEREST OF FAST MOVING TRAFIC ALONG MINIMUM ACQUISITION OF VALUABLE LAND AND HOMESTEADS WHICH ARE ESSENTIAL TO BE ACQUIRED FOR THE CONSTRUCTION / IMPROVEMENT OF THE ROAD AND CAN NOT BE AVOIDED.**

*Sudip*

Junior Engineer  
N.H. Planning & Design Division-I  
P.W. (Roads) Directorate  
Govt. of West Bengal

*h*

Assistant Engineer  
N.H. Planning & Design Division-II  
P.W. (Roads) Directorate  
Govt. of West Bengal

*FB*

Executive Engineer  
N.H. Planning & Design Division  
P.W. (Roads) Directorate  
Govt. of West Bengal

*Shankar*

Superintending Engineer  
N.H. Planning & Design Circle  
P.W. (Road) Directorate  
Govt. of West Bengal



LAND ACQUISITION PROPOSAL FOR CONSTRUCTION OF ROB AT KM 338.000 (SURI) OF NH60 IN BIRBHUM DISTRICT, WEST BENGAL.

MOUZA - ABDARPUR, J.L. NO. - 97, P.S. - SURI, DIST. - BIRBHUM

Chainage From - 337 + 936 Km. to 339 + 046 Km.  
Length - 1110 M.

SCALE :- 16 INCH = 1 MILE



*Signature*

W. J. Planning & Design Circle  
P. W. (Road) Directorate  
Govt. of West Bengal

W. J. Planning & Design Circle  
P. W. (Road) Directorate  
Govt. of West Bengal

*Signature*

W. J. Planning & Design Circle  
P. W. (Road) Directorate  
Govt. of West Bengal

*Signature*  
Superintending Engineer  
N.H. Planning & Design Circle  
P. W. (Road) Directorate  
Govt. of West Bengal