

PLAN OF LAND TO BE ACQUIRED PERMANENTLY FOR CONSTRUCTING THE PROPOSED
WATER COURSE TAKING OFF FROM CH. 66.00 OF M.B.B.C IN MOUZA (T) MONPUR
J.L.NO - 31, (2) DHALLA J.L.NO - 26, P.S. SURI, DIST - BIRBHUM.

SCALE 16" = 1 MILE.

L.A. case no. 47/67-68

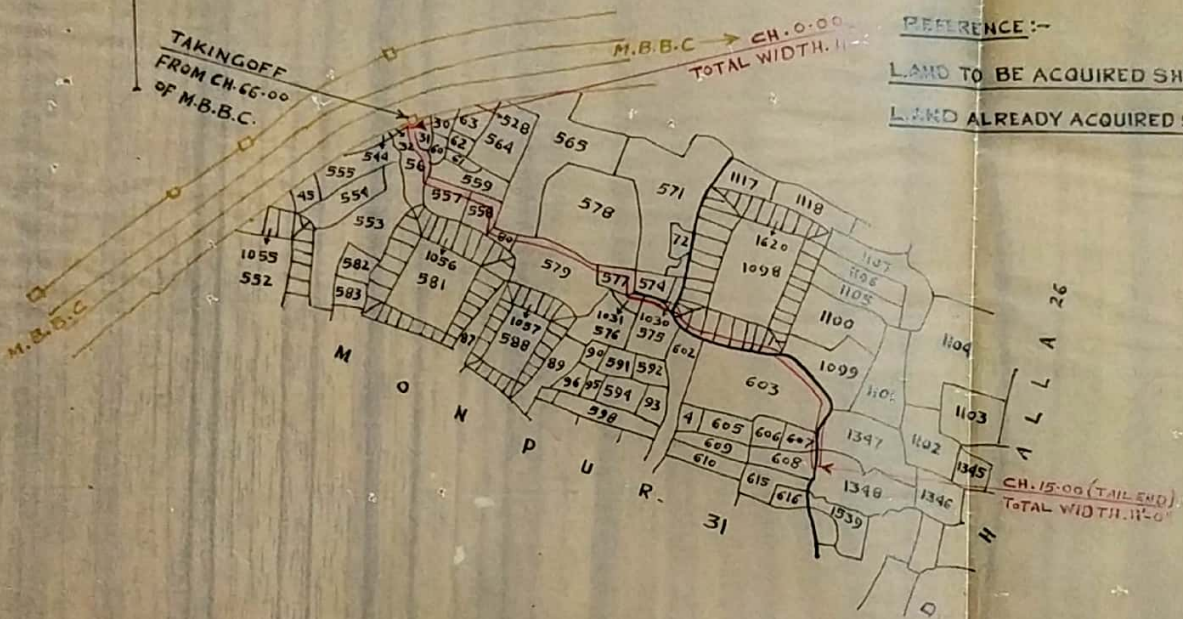

REFERENCE :-

LAND TO BE ACQUIRED SHOWN THUS - ---
LAND ALREADY ACQUIRED SHOWN THUS - ---

SCHEDULE OF LANDS.

MOUZA	J.L.NO	P.S.	DIST	C.S. PLOTS	AREA
<u>DHALLA</u>	<u>26</u>	<u>SURI</u>	<u>BIRBHUM</u>	IN PART - 1098/1620, 1347 AND 1348	0.075
<u>MONPUR</u>	<u>31</u>	<u>DO</u>	<u>DO</u>	IN PART - 532, 556, 557, 558, 575, 577, 579, 580, 603, 607, 608, 574/1030 AND 576/1031.	0.275
TOTAL					0.35

TRACED BY - G. Ghosh
22/11/68

CKD BY *[Signature]*
25/11/68
Kgn.

[Signature]
25/11/68
SPL. L.A. COLLECTOR
SURI, BIRBHUM.