

PLAN OF LAND TO BE ACQUIRED FOR CONSTRUCTION OF J.D.B PROJECT OF WIDENING OF PANAGARH-DUBRAJPUR-MOREGRAM ROAD SEC.FROM 55.496KM TO 57 KM IN MOUZA-BANGAON-J.L.NO-131 P.S.SURI AND SADDAPUR.J.L.NO-93, CHAKDUBRAJPUR.J.L.NO-92 P.S. DUBRAJPUR. IN THE DISTRICT OF BIRBHUM.

SCALE-330'=1" INCH.

REP:
 LAND TO BE ACQUIRED SHOWN THUS---
 VESTED & PARTLY VESTED LAND " " ---
 HOME-STEAD LAND NOT TO BE ACQD. " " ---
 LAND ALREADY ACQD. BY BAKRESWAR T.P. PROJECT SHOWN THUS---

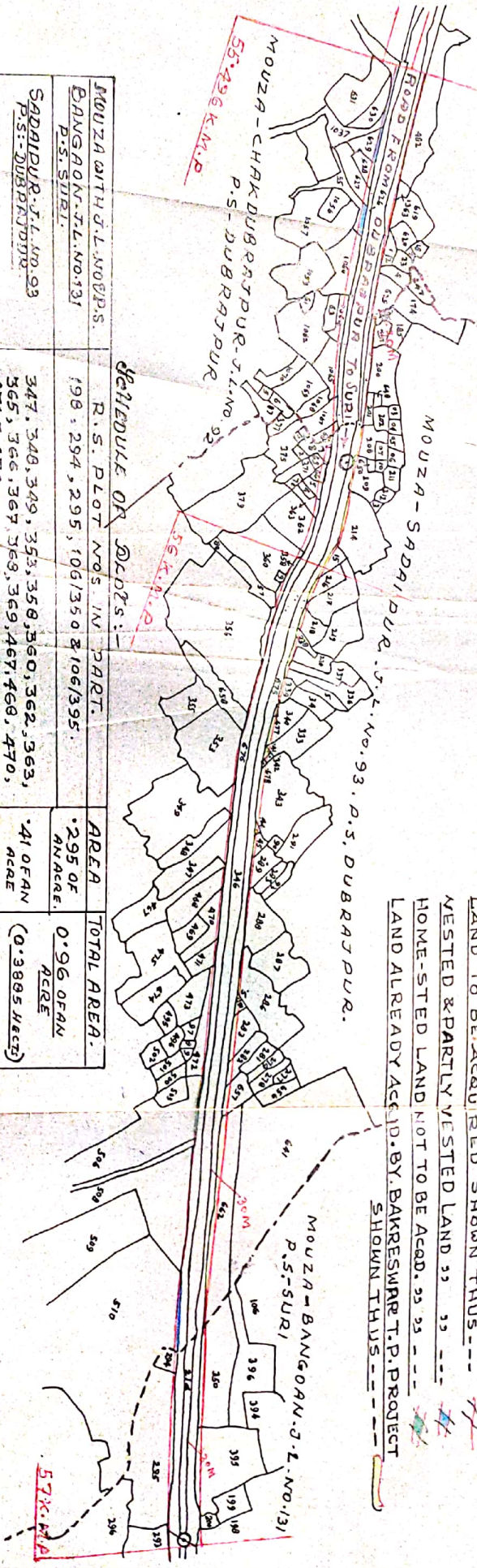

SCHEDULE OF DEBTS:-

MOUZA WITH J.L.NO & P.S.	R.S. PLOT NOS IN PART.	AREA OF ANACRE.	TOTAL AREA. ACRES
BANGAON-J.L.No.131 P.S.SURI.	198, 294, 295, 106/350 & 106/395.	295 OF ANACRE.	0.96 OF AN ACRES
SADDAPUR-J.L.No.93 P.S. DUBRAJPUR.	347, 348, 349, 353, 358, 360, 362, 363, 365, 366, 367, 369, 369, 467, 468, 470, 471 & 472.	41 OF AN ACRES	(0.3805 HECT)
CHAKDUBRAJPUR-J.L.No.92 P.S. DUBRAJPUR.	627, 628, 1060, 1064, 1065, 1066 & 1067	255 OF ANACRE	

DRAWN BY: *[Signature]*

VERIFIED: *[Signature]*

DATE: 13.8.92

ADDL. L.A. OFFICER, BIRBHUM.

ADDL. DIST. MAGISTRATE, BIRBHUM.