

PLAN  
OF LAND TO BE ACQUIRED PERMANENTLY FOR CONSTRUCTION OF  
DISTY. No 6/2/1/1B OF B.N.M.C. FROM CH. 0'00 TO CH. 38'00.  
IN MOUZA THAKURPUR. No 146 & CHAK GOPAL. No 147.  
THANA NALHATI. DISTRICT BIRBHUM.

Scale - 16" = 1 Mile.

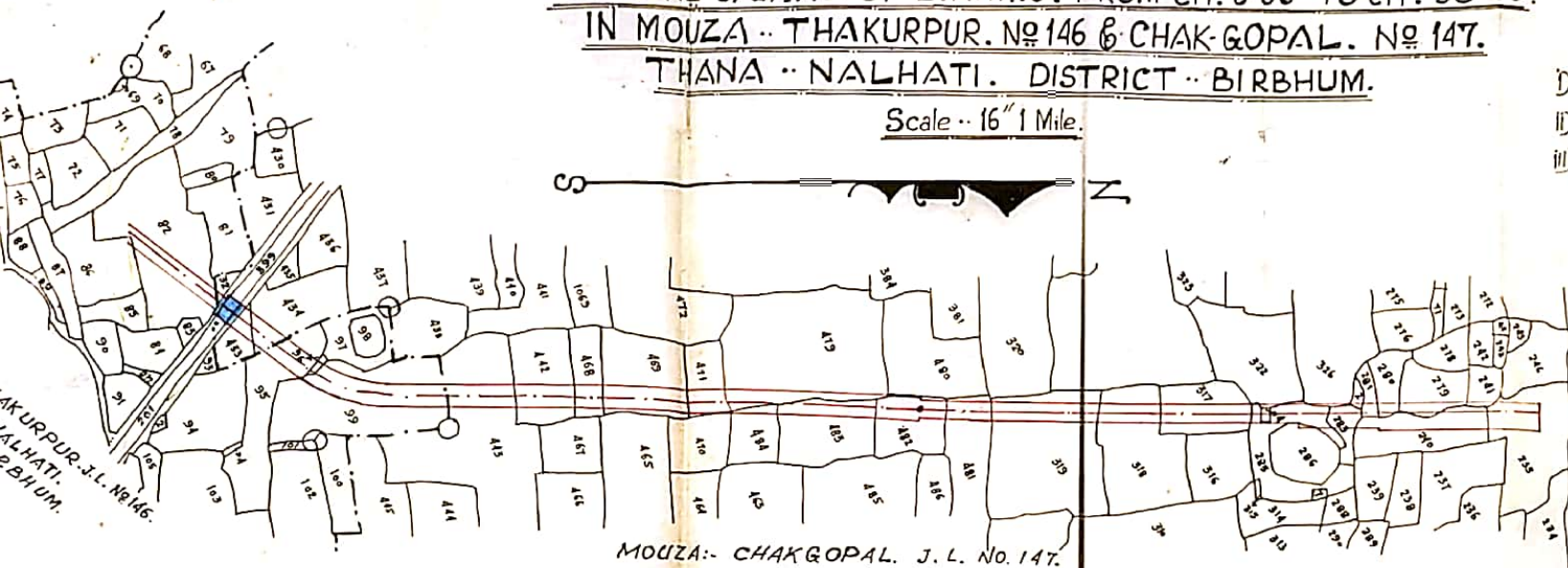

Schedule Of Lands.

Mouza.	J.L.No.	Thana.	District.	c.s.plot Nos In Full.	c. s. plot. Nos In part.	Area
Thakurpur.	146.	Nalhati.	Birbhum.	x	82, 86, 95, 96 And 99	0.925 Acres
Chakgopal.	147.	DO.	DO.	284. Only	235, 240, 241, 217, 280, 281, 282, 283, 285, 286, 317, 318, 319, 322, 324, 352, 433, 434 442, 443, 468, 469, 470, 471, 472, 460, 481, 482, 483 And 484	3.875 "
<b>Total</b>						<b>4.80 Acres</b>

CKD. BY.

*Subbar*  
30.5.60

30/5/60

SP

*Copy attached.*

Ref.

i) Land Already Acquired In L.A. Case No 103 Of 53-54 Shown Thus. ...

ii) Land To Be Acquired Permanently Shown Thus. ...

iii) Land Not To Be Acquired Shown Thus. ...

*I. By. Roy.*

*Retel 31*

Addl. L.A. Collector  
Birbhum.