

PLAN OF LAND TO BE ACQUIRED PERMANENTLY FOR CONSTRUCTING A NEW SUB-MINOR 51 WITH ITS WATER-COURSE NO-1 AND CONTINUED WATER-COURSE AT TAIL, OFF TAKING FROM (H. 346'00 (L.B.) OF MINOR NO 2 OF DY NO 2 OF K.S.M.C. OF MOUZAS-BANDAR, NO. 76, SHAKBAHA-NO-79 AND BHETER, NO. 80, P.S. NANUR AND DISTRICT- BIRBHUM.

SCALE - 330' = 1"

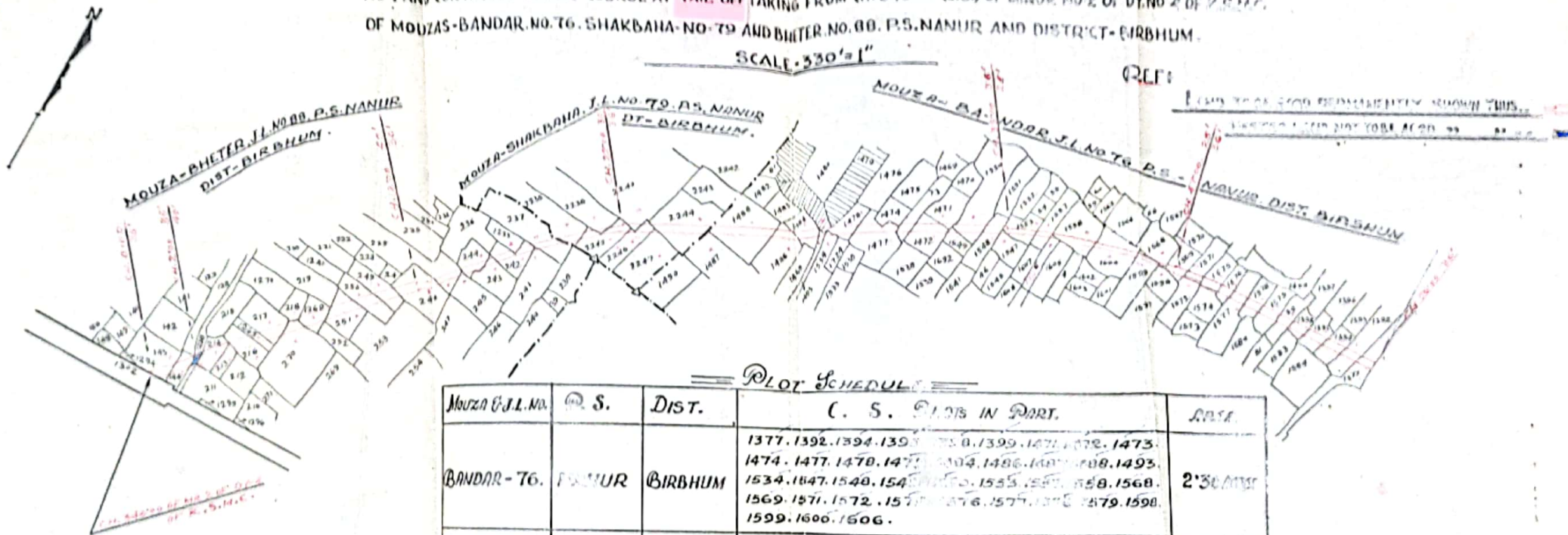

Plot Schedule

| Mouza & J.L. No. | P. S. | DIST.   | C. S. PLOTS IN PART.  | AREA.             |
|------------------|-------|---------|---|-------------------|
| BANDAR-76.       | NANUR | BIRBHUM | 1377, 1392, 1394, 1397, 1398, 1399, 1471, 1472, 1473, 1474, 1477, 1478, 1479, 1480, 1486, 1487, 1488, 1493, 1534, 1547, 1548, 1549, 1550, 1551, 1552, 1553, 1554, 1555, 1556, 1557, 1558, 1568, 1569, 1571, 1572, 1573, 1574, 1575, 1576, 1577, 1578, 1579, 1598, 1599, 1606, 1606. | 2'30 ACRES        |
| SHAKBAHA-79.     | Do.   | Do.     | 2235, 2236, 2240, 2241, 2245, 2246, 2247.   | '47 OF 200 ACRES. |
| BHETER-80.       | Do.   | Do.     | 143, 144, 213, 214, 216, 217, 218, 219, 237, 241, 242, 243, 244, 245, 248, 249, 251, 257, 270, 1233, 1265 AND 1265.   | 1'53 ACRES.       |

TOTAL AREA 4'30 ACRES.

PREPARED BY: [Signature]

CHKD. BY: [Signature]

SO. L.S. OFFICER, BIRBHUM.