

PLAN
LAND TO BE ACQUIRED PERMANENTLY
FOR A LEAD CHANNEL FROM CH. 626.00 (RT.)
OF B.N.M.C. IN MOUZA-PAIKPARA U.L.NO. 57
P.S. NALHATI; DIST. BIRBHUM
SCALE: -330' = 1"

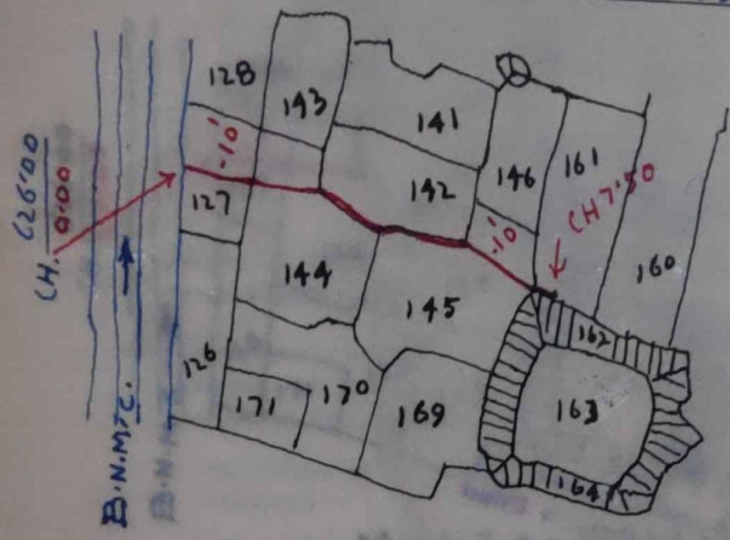

Verified and found correct
[Signature]
 Sub. District Engineer
 Nalhati I
 O. Nalhati, Dt. Birbhum.

Verified and found correct.

MOUZA - PAIKPARA U.L.NO.57

REF:-

LAND ALREADY ACQUIRED SHOWN THUS: - ||||
LAND TO BE ACQUIRED SHOWN THUS: - ||||-

SCHEDULE OF LANDS

MOUZA	U.L.NO.	P.S.	C.S. PLOT NOS.	AREA
PAIKPARA	57	NALHATI	127. 142. 144. 145 AND 161 - IN PART.	0.17 OF ANACRE

CKD. BY.

[Signature]
 5.1.81 Kgo.

PREPARED BY:-
S. Banerjee
 15.5.80

[Signature]
 SPL. L.A. OFFICER
BIRBHUM