

PLAN
OF LAND TO BE ACQUIRED FOR THE CONSTRUCTION
OF HOUSES OF SARBOODAY ASHRAM AT NALHATI
IN MOUZA - PAIKPARA J.L.NO.57; P.S. NALHATI; DIST. BIRBHUM

SCALE:-330'=1"

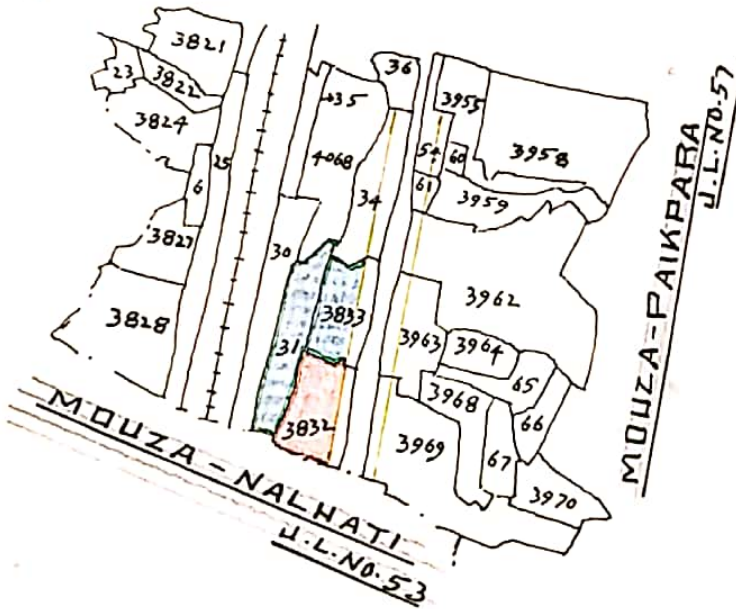

REF:-
LAND ALREADY ACQUIRED BY ROAD DEPT. SHOWN T
(VIDE CASE NO.97/59-60)

LAND POSSESSED BY SARBOODAY ASHRAM SHOWN THUS:- 
LAND TO BE ACQUIRED SHOWN THUS:- 

SCHEDULE OF LAND

MOUZA	J.L.NO.	P.S.	DIST.	C. S. PLOT NO.	AREA
PAIKPARA	57	NALHATI	BIRBHUM	3832 - IN PART.	0.44 ACRE

CKD.BY.

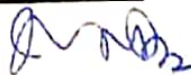

KGO.

15/1/71

DRAWN BY:- S. Banerji

SPL. L. A. OFFIC
BIRBHUM

PLAN
 OF LAND TO BE ACQUIRED PERMANENTLY
 FOR ~~CONSTRUCTION~~ ^{PURPOSE} OF SARBODAY ASRAM AT
~~JAGIGRAM~~ ^{NALHATI} IN MOUZA PAIKPARA J.L.NO. 57
 P. S. NALHATI; DIST. BIRBHUM

SCALE: - 330' = 1"

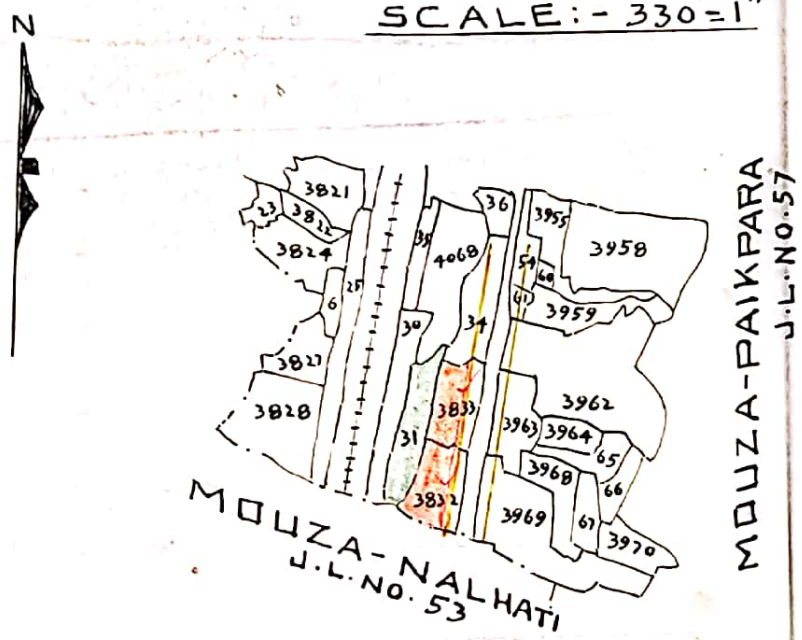

REF:-
 LAND ALREADY POSSESSED BY:
 SARBODAY ASRAM SHOWN THUS: -
 LAND ALREADY ACQUIRED BY ROADS
 DEPTT. VIDE CASE NO. 97/59-60 SHOWN THUS: -
 LAND TO BE ACQUIRED SHOWN THUS: -

SCHEDULE OF LANDS

MOUZA	J.L.NO.	P.S.	DIST.	G. S. PLOT NOS.	AREA
PAIKPARA	57	NALHATI	BIRBHUM	3832 ✓ AND 3833 ✓ - IN PART.	0.81 ✓ ACRE

CKD. BY.

J. Chandra Shekhar
 17-9-65
 SURVEYOR

TRACED BY:-
S. B. Chandra

D. Kumar
 22.10.61
 S.P.L. L.A. COLLECTOR
 BIRBHUM