

Traced By: *[Signature]*

*[Signature]*  
18/04/89  
CRD.BY

Spl. L.A. Collector  
Bijdhum

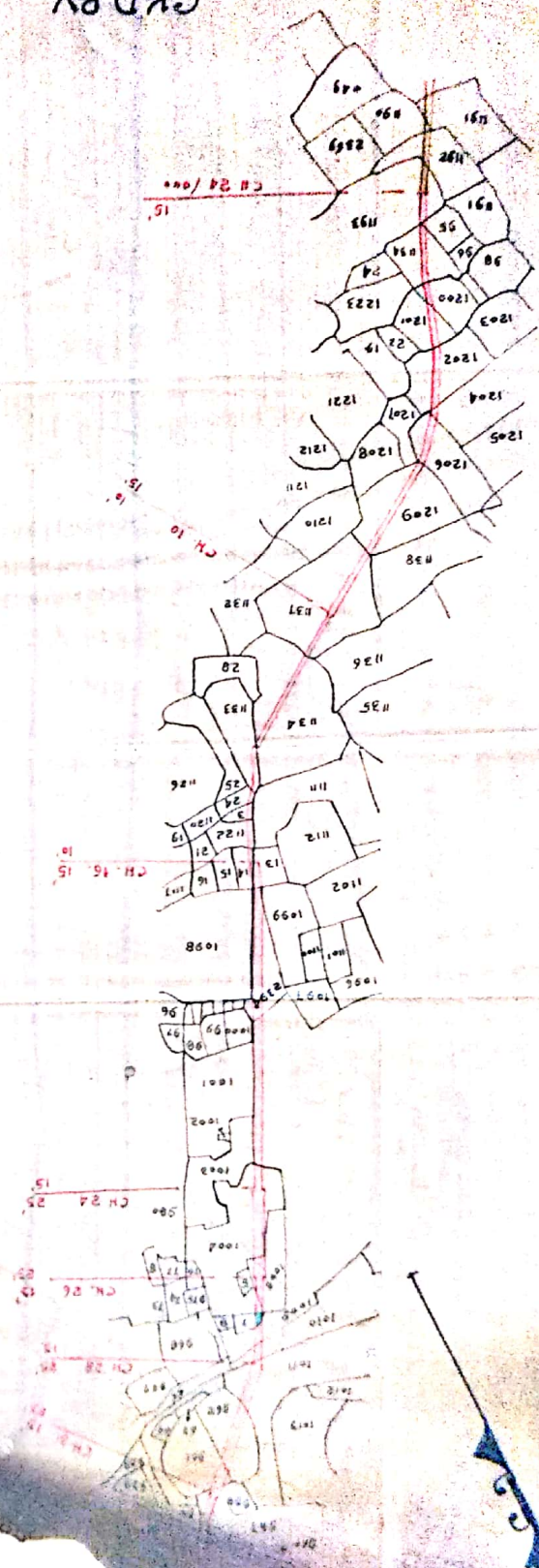

Schedule-Of-Lands.

Mouza.	J.L.N <sup>o</sup>	P. S.	District.	G. s. plot Nos.	Area.
Fatepura.	26.	Magureswar.	Bijdhum.	88, 94a, 957, 958, 961, 962, 1041, 1046, 1069, 1070, 1071, 1089, 1113, 1114, 1123, 1124, 1133, 1134, 1137, 1193, 1194, 1195, 1200, 1201, 1202, 1204, 1206, 1209, 1209 And 1098/2394. In Part.	(421 Acres.) 4897 Hectare

- (i) Land Already Acquired Permanently Shown Thus..
- (ii) Land To Be Acquired Permanently Shown Thus..
- (iii) Vested Land Not To Be Acquired. Shown Thus..

Rep.  
330.1 (mcm)