

PLAN
OF LAND TO BE ACQUIRED PERMANENTLY FOR THE CONSTRUCTION
OF ABINASHPUR TO SAHAPUR V.R. (SECTION I.M.P. TO 2ND M.P.)
IN MOUZA-RAIPUR J.L.No.176 ; DOMAIPUR J.L.No.158, P.S.SURI, DIST. BIRBHUM
SCALE: - 330' = 1"

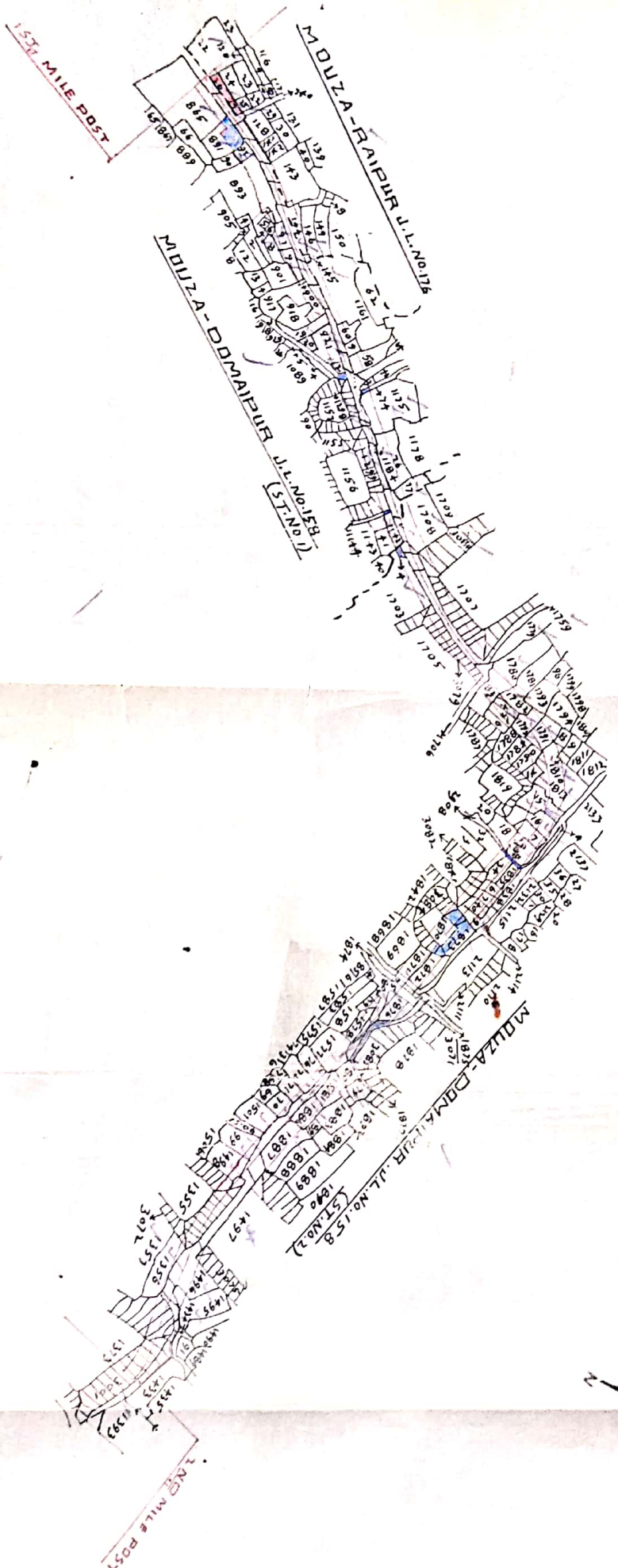

SCHEDULE OF LAND

MOUZA	J.L.No.	P.S.	DIST.	C.S. PLOT NOS.	AREA ACRES
RAIPUR	176	SURI	BIRBHUM	145-IN FULL TL. 144 AND 146 - IN PART	777
DOMAIPUR	158	DO	DO	1834 - IN FULL 1835 - IN PART 1836 - IN FULL 1837 - IN PART 1838 - IN FULL 1839 - IN PART 1840 - IN FULL 1841 - IN PART 1842 - IN FULL 1843 - IN PART 1844 - IN FULL 1845 - IN PART 1846 - IN FULL 1847 - IN PART 1848 - IN FULL 1849 - IN PART 1850 - IN FULL 1851 - IN PART 1852 - IN FULL 1853 - IN PART 1854 - IN FULL 1855 - IN PART 1856 - IN FULL 1857 - IN PART 1858 - IN FULL 1859 - IN PART 1860 - IN FULL 1861 - IN PART 1862 - IN FULL 1863 - IN PART 1864 - IN FULL 1865 - IN PART 1866 - IN FULL 1867 - IN PART 1868 - IN FULL 1869 - IN PART 1870 - IN FULL 1871 - IN PART 1872 - IN FULL 1873 - IN PART 1874 - IN FULL 1875 - IN PART 1876 - IN FULL 1877 - IN PART 1878 - IN FULL 1879 - IN PART 1880 - IN FULL 1881 - IN PART 1882 - IN FULL 1883 - IN PART 1884 - IN FULL 1885 - IN PART 1886 - IN FULL 1887 - IN PART 1888 - IN FULL 1889 - IN PART 1890 - IN FULL 1891 - IN PART 1892 - IN FULL 1893 - IN PART 1894 - IN FULL 1895 - IN PART 1896 - IN FULL 1897 - IN PART 1898 - IN FULL 1899 - IN PART 1900 - IN FULL 1901 - IN PART 1902 - IN FULL 1903 - IN PART 1904 - IN FULL 1905 - IN PART 1906 - IN FULL 1907 - IN PART 1908 - IN FULL 1909 - IN PART 1910 - IN FULL 1911 - IN PART 1912 - IN FULL 1913 - IN PART 1914 - IN FULL 1915 - IN PART 1916 - IN FULL 1917 - IN PART 1918 - IN FULL 1919 - IN PART 1920 - IN FULL 1921 - IN PART 1922 - IN FULL 1923 - IN PART 1924 - IN FULL 1925 - IN PART 1926 - IN FULL 1927 - IN PART 1928 - IN FULL 1929 - IN PART 1930 - IN FULL 1931 - IN PART 1932 - IN FULL 1933 - IN PART 1934 - IN FULL 1935 - IN PART 1936 - IN FULL 1937 - IN PART 1938 - IN FULL 1939 - IN PART 1940 - IN FULL 1941 - IN PART 1942 - IN FULL 1943 - IN PART 1944 - IN FULL 1945 - IN PART 1946 - IN FULL 1947 - IN PART 1948 - IN FULL 1949 - IN PART 1950 - IN FULL 1951 - IN PART 1952 - IN FULL 1953 - IN PART 1954 - IN FULL 1955 - IN PART 1956 - IN FULL 1957 - IN PART 1958 - IN FULL 1959 - IN PART 1960 - IN FULL 1961 - IN PART 1962 - IN FULL 1963 - IN PART 1964 - IN FULL 1965 - IN PART 1966 - IN FULL 1967 - IN PART 1968 - IN FULL 1969 - IN PART 1970 - IN FULL 1971 - IN PART 1972 - IN FULL 1973 - IN PART 1974 - IN FULL 1975 - IN PART 1976 - IN FULL 1977 - IN PART 1978 - IN FULL 1979 - IN PART 1980 - IN FULL 1981 - IN PART 1982 - IN FULL 1983 - IN PART 1984 - IN FULL 1985 - IN PART 1986 - IN FULL 1987 - IN PART 1988 - IN FULL 1989 - IN PART 1990 - IN FULL 1991 - IN PART 1992 - IN FULL 1993 - IN PART 1994 - IN FULL 1995 - IN PART 1996 - IN FULL 1997 - IN PART 1998 - IN FULL 1999 - IN PART 2000 - IN FULL	277

CKDBY

Handwritten signature
 KGO.

APPL. L.A. OFFICER
 BIRBHUM