

PLAN SHOWING THE PARTLY VESTED LAND UNDER THE PROVISION
OF W.B. E.A. ACT. OF MOUZA. SITALGRAM. J.L. No. 135. P.S. NALHATI,

DT. BIRBHUM.

SCALE: - 16" = 1 MILE.

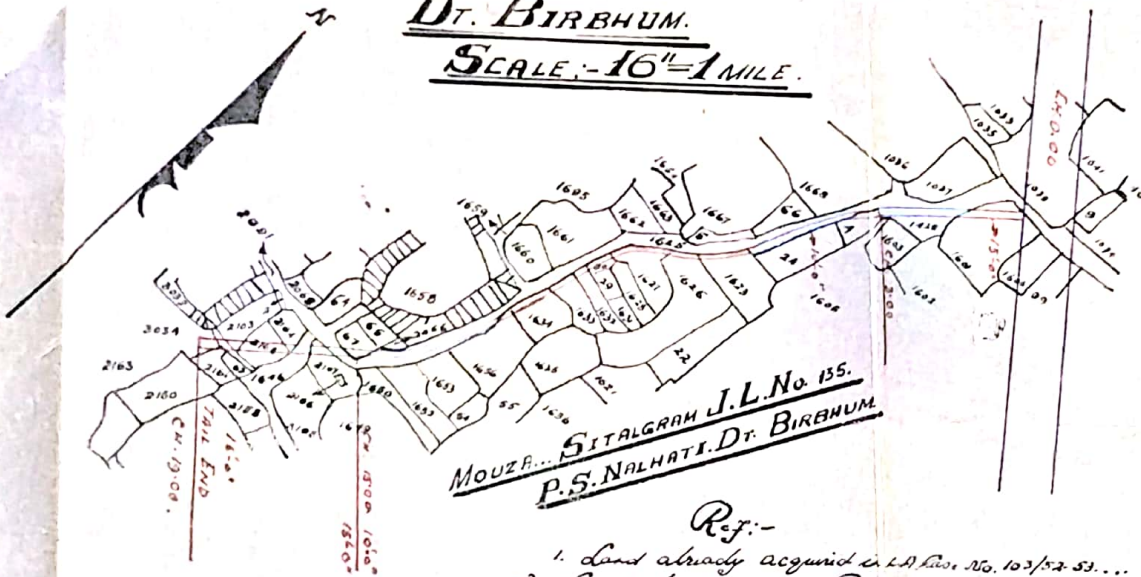

MOUZA. SITALGRAM J.L. No. 135.
P.S. NALHATI. DT. BIRBHUM.

Ref:-

1. Land already acquired in L.A. No. 103/52-53.
2. Land to be acquired Permanently.
3. Vested land to be acquired.
4. Plot under demarcation - 2067,

Survey's Office
 29.5.68

PREPARED BY.

LKD. BY.

From
 4668
 Kgo.

SPL. L.A. OFFICER.

BIRBHUM.